

Revision:	Changes:	Date:
1.0	Initial Case	2021.02.11
1.1	Adding Inch Unit	2021.08.25
1.2	PCB Update-Change the touch ZIF connector	2021.08.26
1.3	PCB Update And Dimensions Overhaul	2022.01.05

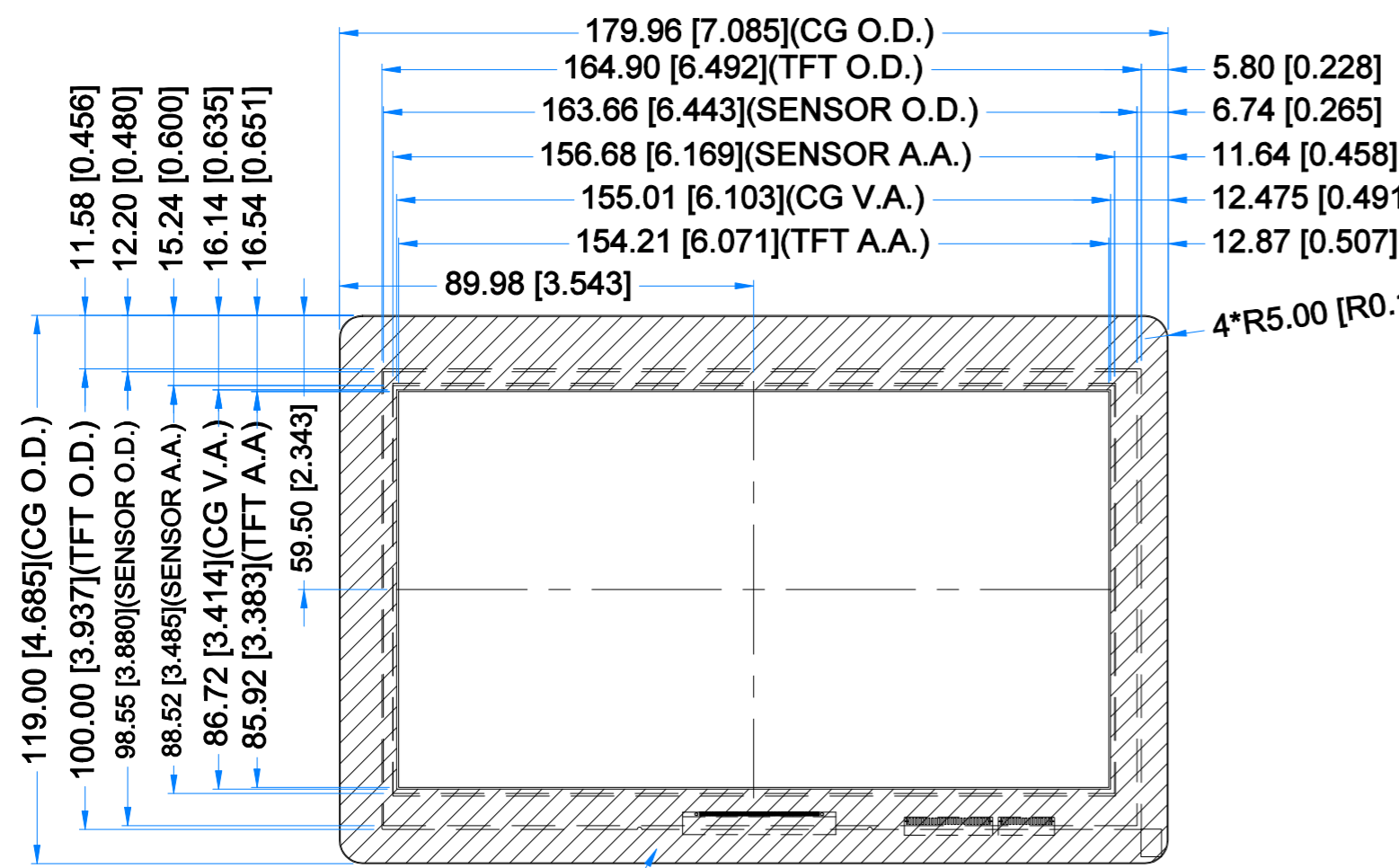

BLACK MASK PRINTING  
RAL9005

DETAIL A  
SCALE 4:1

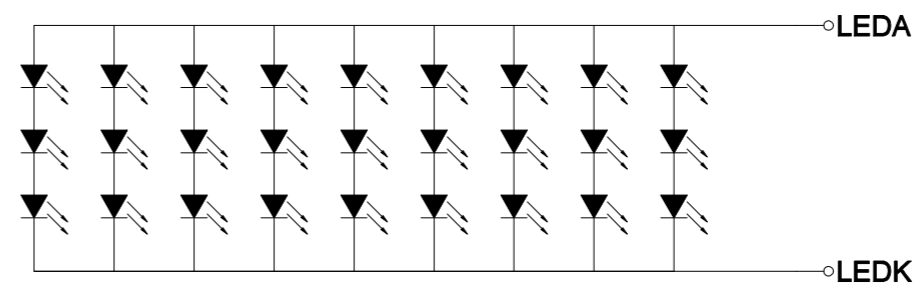
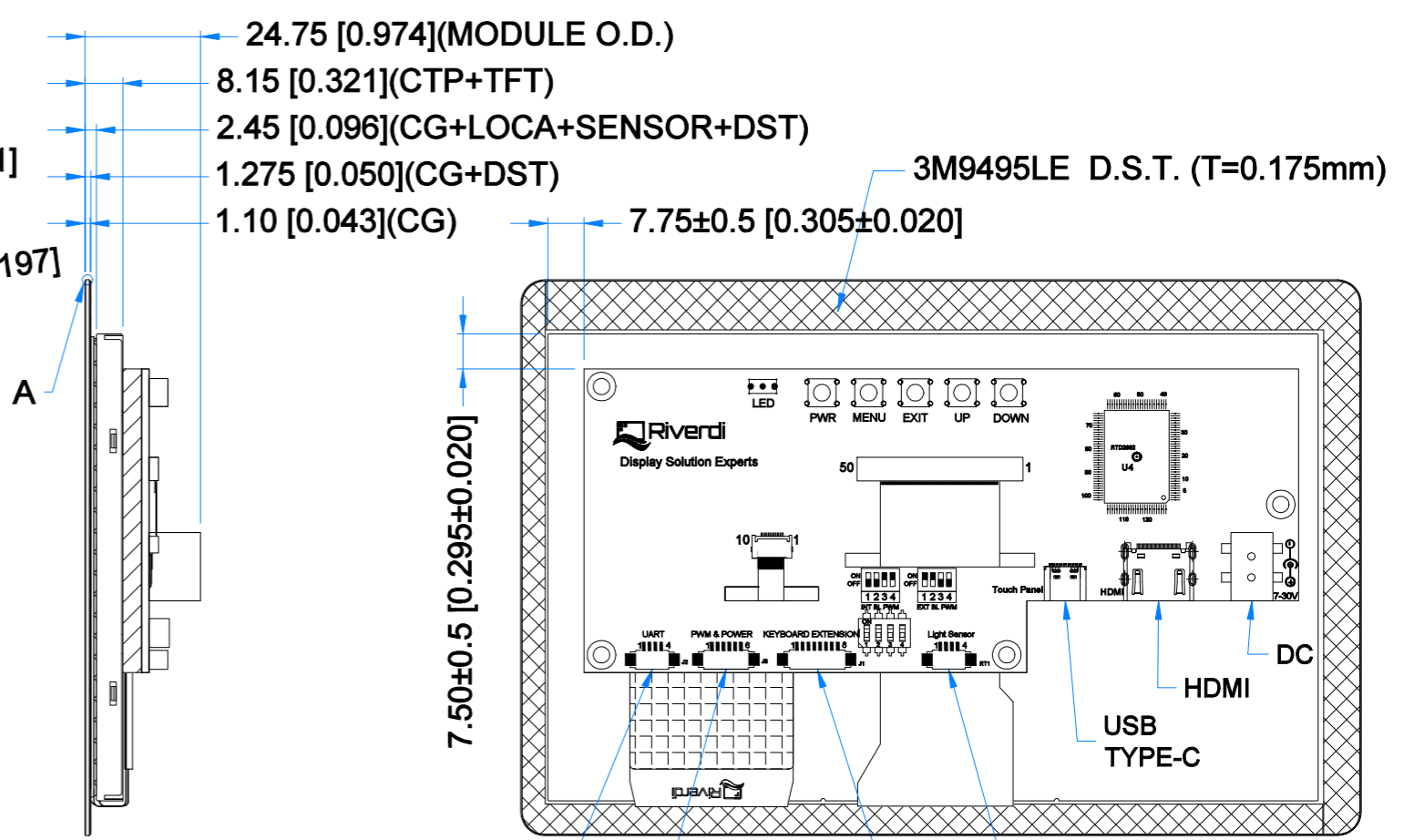
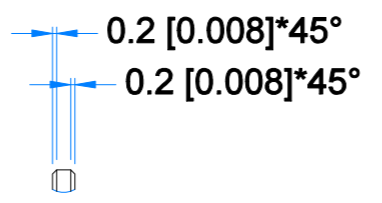

LED Diagram Circuit

**LCM NOTES:**  
 1. LCD TYPE: TRANSMISSIVE, NORMALLY BLACK, IPS  
 2. RESOLUTION: 1024x600  
 3. VIEWING ANGLE: FREE  
 4. MODULE SURFACE LUMINANCE: MAX. 800 cd/m<sup>2</sup>  
 5. CONTROLLER IC OF MAIN BOARD: RTD2662  
 6. VIDEO INTERFACE: HDMI  
 7. POWER SUPPLY: POWER JACK (7.0-30.0V); USB-C.

**TP NOTES:**  
 1. TP STRUCTURE: G+G  
 2. CG THICKNESS: 1.10 mm  
 3. DRIVER IC: ILI2132A  
 4. TOUCH PANEL INTERFACE: USB-C

**GENERAL NOTES:**  
 1. OPERATING TEMPERATURE: -20°C ~ 70°C  
 2. STORAGE TEMPERATURE: -30°C ~ 80°C  
 3. WITHOUT INDIVIDUAL TOLERANCE: ±0.3mm  
 4. RoHS3 COMPLIANT

PN: RVT70HSHNWC00  
 SN:  
 DRAWN: M.Natywa  
 CHECKED: Carol Gao  
 APPR:



2022.01.05 1:1.48  
 2022.01.13 [mm]  
 ISO A3 P. 1 of 1



**EXTERNAL KEYBOARD CONNECTOR - J1**

Pin No.	Desc.	Pin No.	Desc.
1	DOWN	2	UP
3	EXIT	4	MENU
5	PWR	6	LED_EN
7	GND	8	KEYBOARD VDD

**BACKLIGHT PWM & POWER - J5**

Pin No.	Desc.	Pin No.	Desc.
1	GND	2	GND
3	EN	4	PWM
5	VDD	6	VDD

**LIGHT SENSOR CONNECTOR - RT1**

Pin No.	Desc.	Pin No.	Desc.
1	GND	2	ADC_IN
3	NC	4	LIGHT SENSOR VDD

**UART CONNECTOR - J2**

Pin No.	Desc.	Pin No.	Desc.
1	GND	2	RXD
3	TXD	4	VDD