

Revision:	Changes:	Date:
1.0	Initial Case	2023.05.24
1.1	PCB Update - 50STM32U5_Rev1.1	2024.07.12

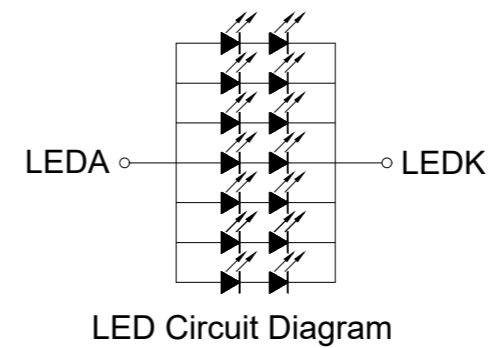
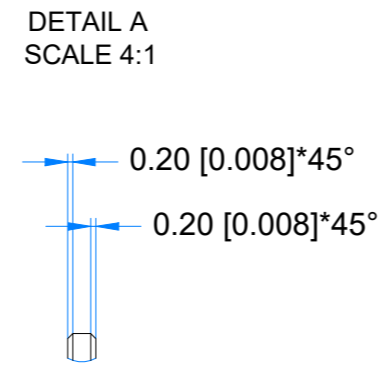
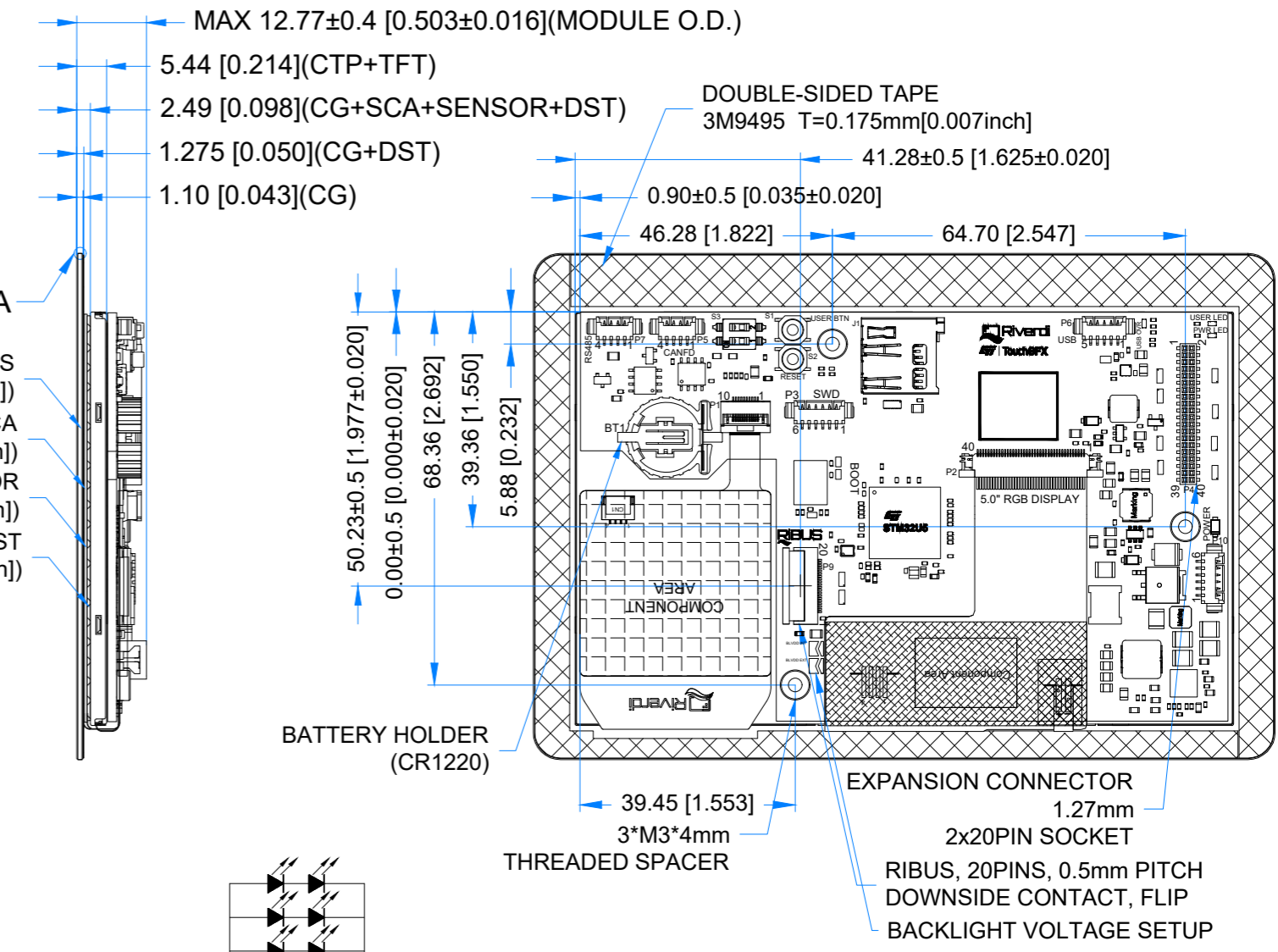
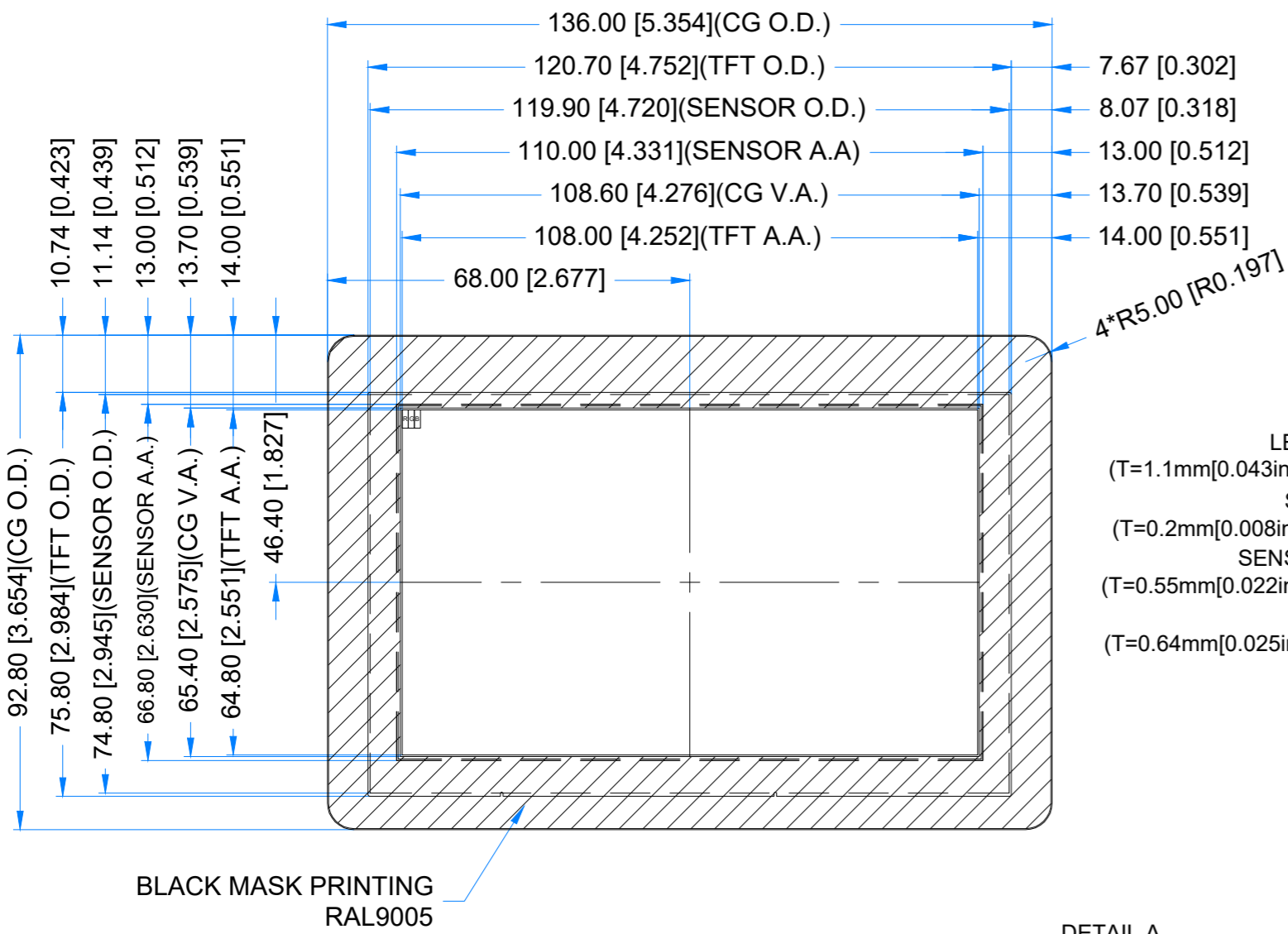

**1.25 MM MOLEX CONNECTORS**

NO.	TYPE	MATE WITH
P3 (SWD)	53261-0671	51021-0600
P5 (CAN)	53261-0471	51021-0400
P6 (USB)	53261-0571	51021-0500
P7 (RS485)	53261-0471	51021-0400
P10 (POWER)	53261-0671	51021-0600

**1.27MM PIN SOCKET**

NO.	TYPE	MATE WITH
P4	CBC1402M100-2P	CH51402M100-0P OR CH51402V100

**TFT NOTES:**  
1. DISPLAY TYPE: TRANSMISSIVE, NORMALLY BLACK, IPS  
2. RESOLUTION: 800x480  
3. VIEWING ANGLE: FREE  
4. SURFACE LUMINANCE: 800 cd/m<sup>2</sup>  
5. MCU ON THE BOARD: STM32U5A9NJH6Q  
6. EXTERNAL FLASH MEMORY SIZE: 512Mbit  
7. SUPPLY VOLTAGE FOR MODULE: 6.0V - 48.0V

**TP NOTES:**  
1. TP STRUCTURE: G+G  
2. CG THICKNESS: 1.10mm[0.043inch]  
3. SURFACE HARDNESS: 7H  
4. DRIVER IC: ILI2132A  
5. INTERFACE: CONNECTED TO MCU VIA I2C

**GENERAL NOTES:**  
1. AIR BONDING  
2. OPERATING TEMPERATURE: -20°C ~ 70°C  
3. STORAGE TEMPERATURE: -30°C ~ 80°C  
4. WITHOUT INDIVIDUAL TOLERANCE: ±0.3mm[0.012inch]  
5. TOLERANCE OF PCB PLACEMENT: ±0.5mm[0.020inch]  
6. RoHS3 COMPLIANT

PN:	RVT50HQSNC00
SN:	
DRAWN:	M.Natywa
CHECKED:	M.Wierzbowski
APPR:	T.Soldat



2024.07.12	1:1.17	
2024.07.12	[mm]	
2024.07.12	ISO A3	