

Revision:	Changes:	Date:
1.0	Initial Case	2023.05.24
1.1	PCB Update - 50STM32U5_Rev1.1	2024.07.12

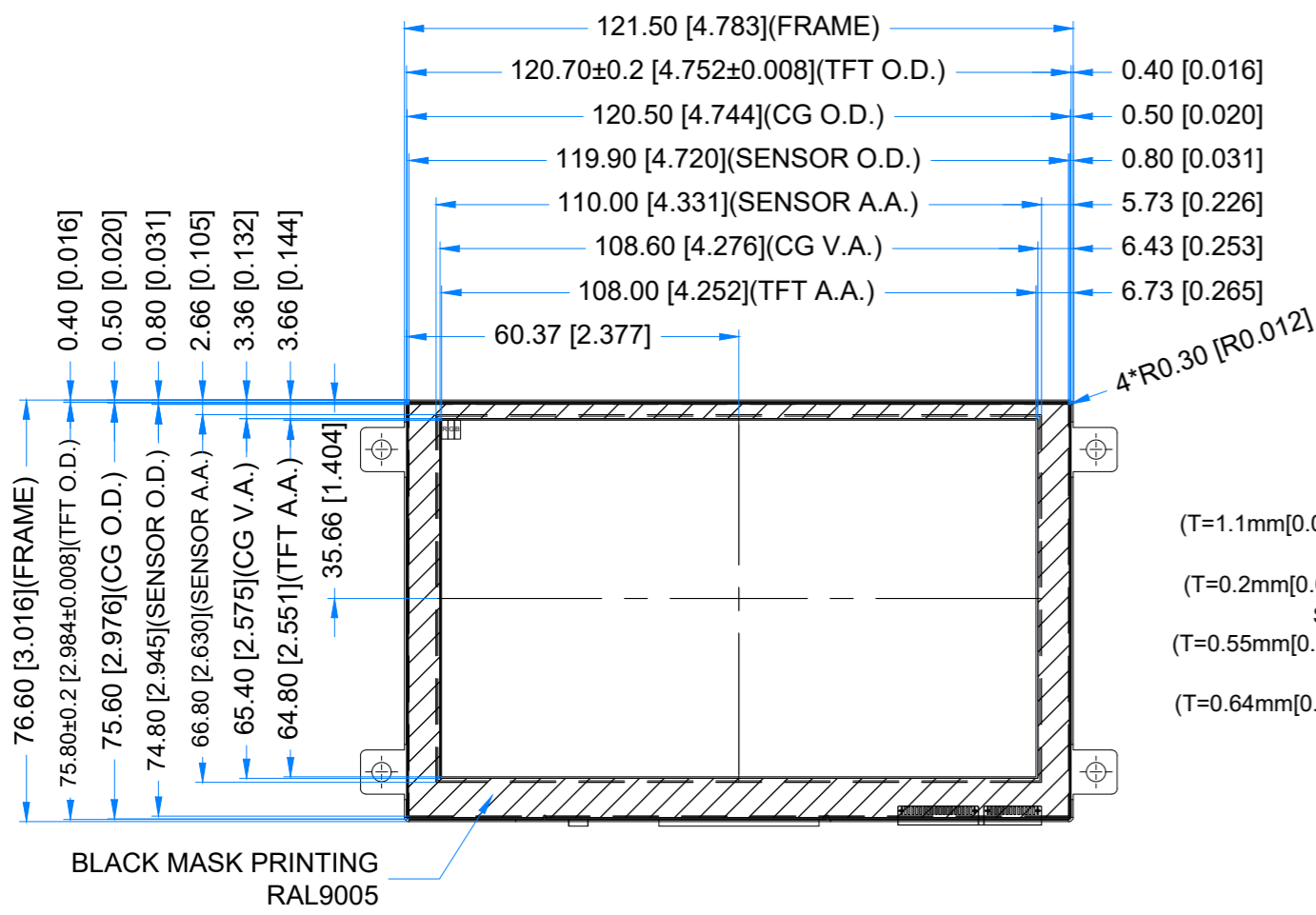

DETAIL A
SCALE 4:1

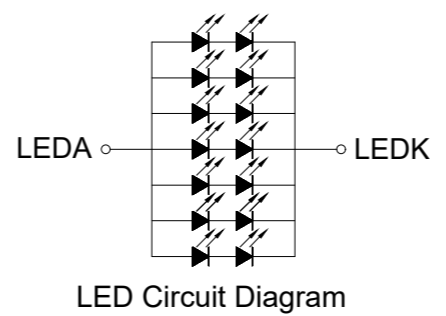
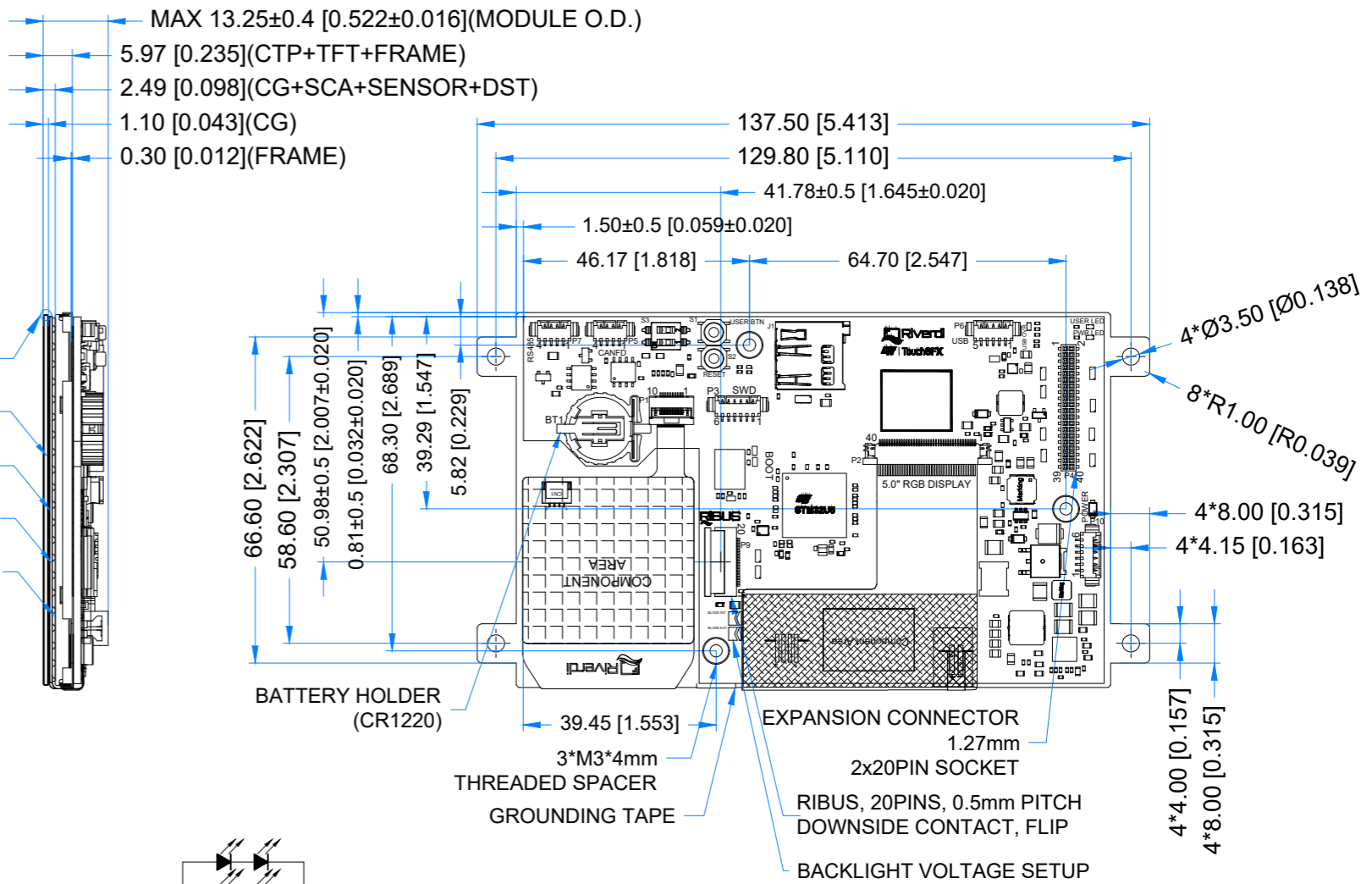
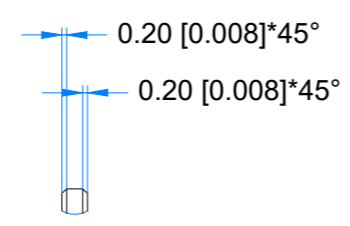

1.25 MM MOLEX CONNECTORS

NO.	TYPE	MATE WITH
P3 (SWD)	53261-0671	51021-0600
P5 (CAN)	53261-0471	51021-0400
P6 (USB)	53261-0571	51021-0500
P7 (RS485)	53261-0471	51021-0400
P10 (POWER)	53261-0671	51021-0600

1.27MM PIN SOCKET

NO.	TYPE	MATE WITH
P4	CBC1402M100-2P	CH51402M100-0P OR CH51402V100

TFT NOTES:
 1. DISPLAY TYPE: TRANSMISSIVE, NORMALLY BLACK, IPS
 2. RESOLUTION: 800x480
 3. VIEWING ANGLE: FREE
 4. SURFACE LUMINANCE: 800 cd/m²
 5. MCU ON THE BOARD: STM32U5A9NJH6Q
 6. EXTERNAL FLASH MEMORY SIZE: 512Mbit
 7. SUPPLY VOLTAGE FOR MODULE: 6.0V - 48.0V

TP NOTES:
 1. TP STRUCTURE: G+G
 2. CG THICKNESS: 1.10mm[0.043inch]
 3. SURFACE HARDNESS: 7H
 4. DRIVER IC: ILI2132A
 5. INTERFACE: CONNECTED TO MCU VIA I2C

GENERAL NOTES:
 1. AIR BONDING
 2. OPERATING TEMPERATURE: -20°C ~ 70°C
 3. STORAGE TEMPERATURE: -30°C ~ 80°C
 4. WITHOUT INDIVIDUAL TOLERANCE:
 ±0.3mm[0.012inch]
 5. TOLERANCE OF PCB PLACEMENT:
 ±0.5mm[0.020inch]
 6. RoHS3 COMPLIANT

PN: RVT50HQSFWCA0			
SN:			
DRAWN: M.Natywa	2024.07.12	1:1.31	
CHECKED: M.Wierzbowski	2024.07.12	[mm]	
APPR: T.Soldat	2024.07.12	ISO A3	