

DETAIL A
SCALE 4:1

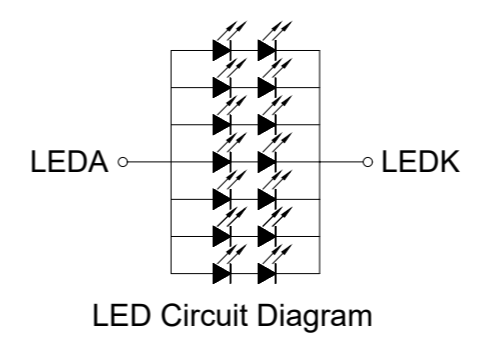
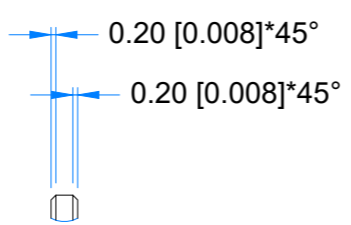

PINOUT ON THE 2ND PAGE

LCM NOTES:
 1. LCD TYPE: TRANSMISSIVE, NORMALLY BLACK, IPS
 2. RESOLUTION: 800x480
 3. VIEWING ANGLE: FREE
 4. MODULE SURFACE LUMINANCE: 850 cd/m²
 4. CONTROLLER IC OF MAIN BOARD: TFP401APZPR
 5. VIDEO INTERFACE: HDMI
 7. POWER SUPPLY: POWER JACK (7.0-36.0V); USB-C.

TP NOTES:
 1. TP STRUCTURE: G+G
 2. CG THICKNESS: 1.10mm[0.043inch]
 3. SURFACE HARDNESS: 7H
 4. DRIVER IC: ILI2132A
 5. INTERFACE:USB-C

GENERAL NOTES:
 1. OPTICAL BONDING BETWEEN TFT AND CTP
 2. OPERATING TEMPERATURE: -20°C ~ 70°C
 3. STORAGE TEMPERATURE: -30°C ~ 80°C
 4. WITHOUT INDIVIDUAL TOLERANCE:
 ±0.3mm[0.012inch]
 5. TOLERANCE OF PCB PLACEMENT:
 ±0.5mm[0.020inch]
 6. RoHS3 COMPLIANT

PN: RVT50HQHNWC00-B			
SN:			
DRAWN: M.Natywa	2023.01.20	1:1.26	
CHECKED: Carol Gao	2023.02.24	[mm]	
APPR:		ISO A3	



BACKLIGHT PWM & POWER - CN1			
Pin No.	Desc.	Pin No.	Desc.
1	VDD	2	VDD
3	PWM	4	EN
5	GND	6	GND