

| Revision: | Changes:  | Date:      |
|-----------|---|------------|
| 1.0       | Initial Case  | 2021.08.09 |
| 1.1       | PCB Update And Added Grounding Tape And Dimensions Overhaul | 2022.08.18 |

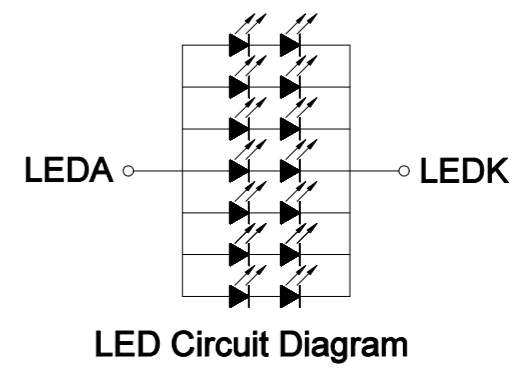
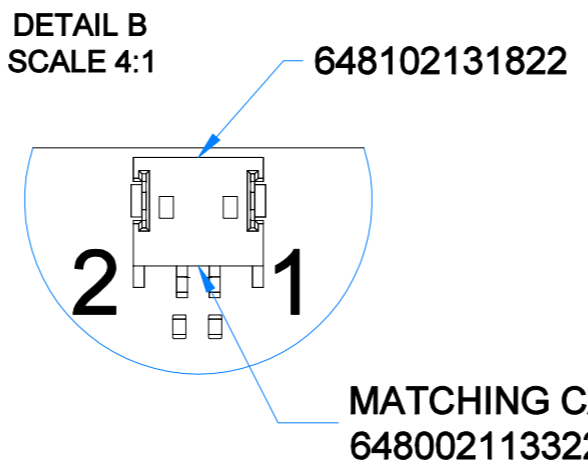
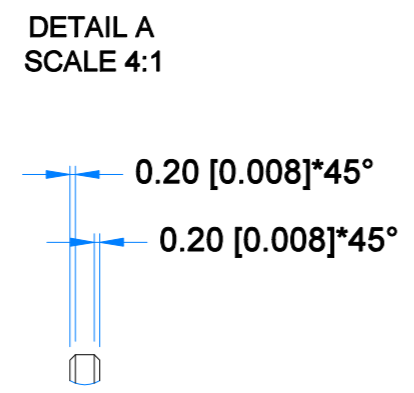
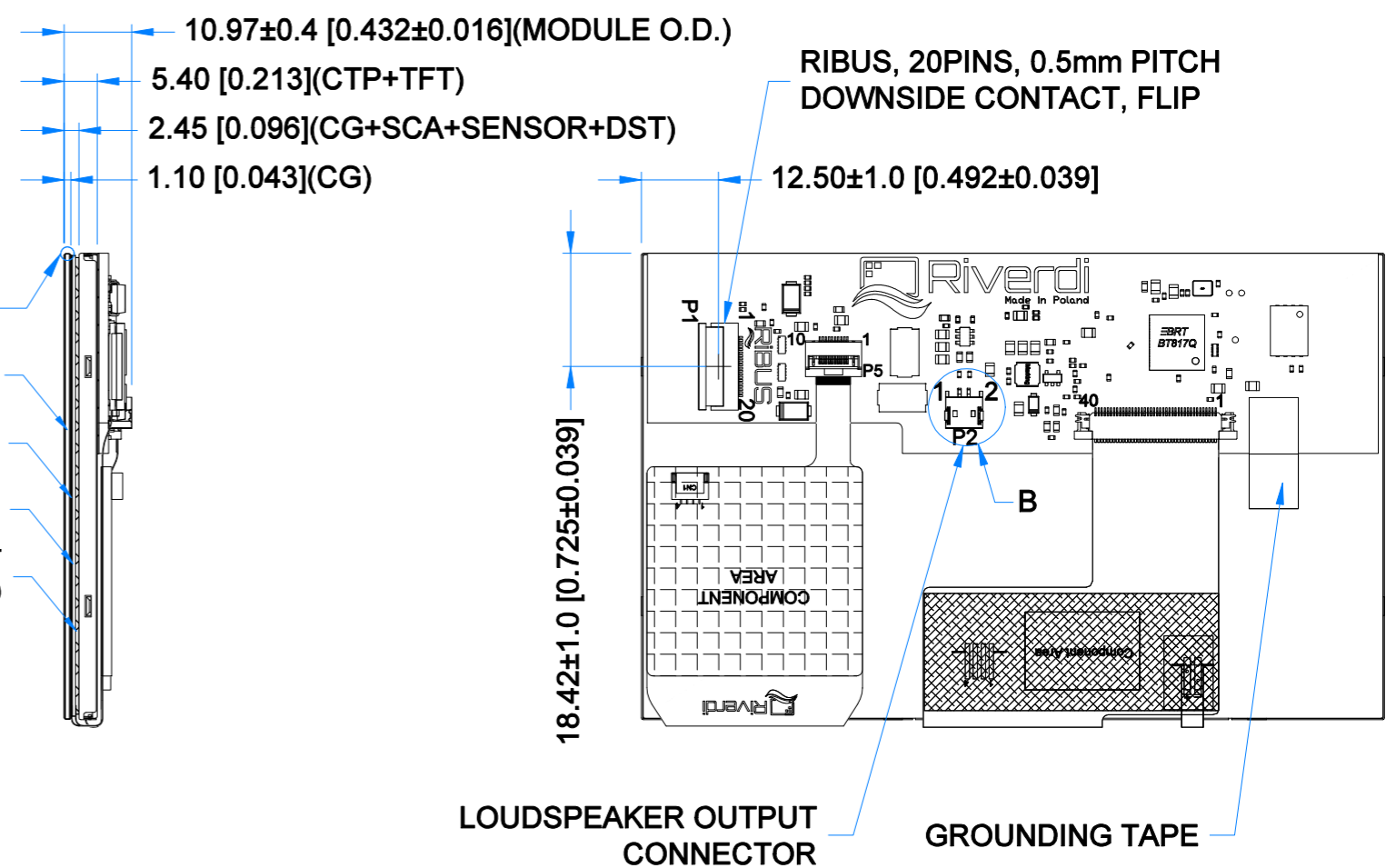
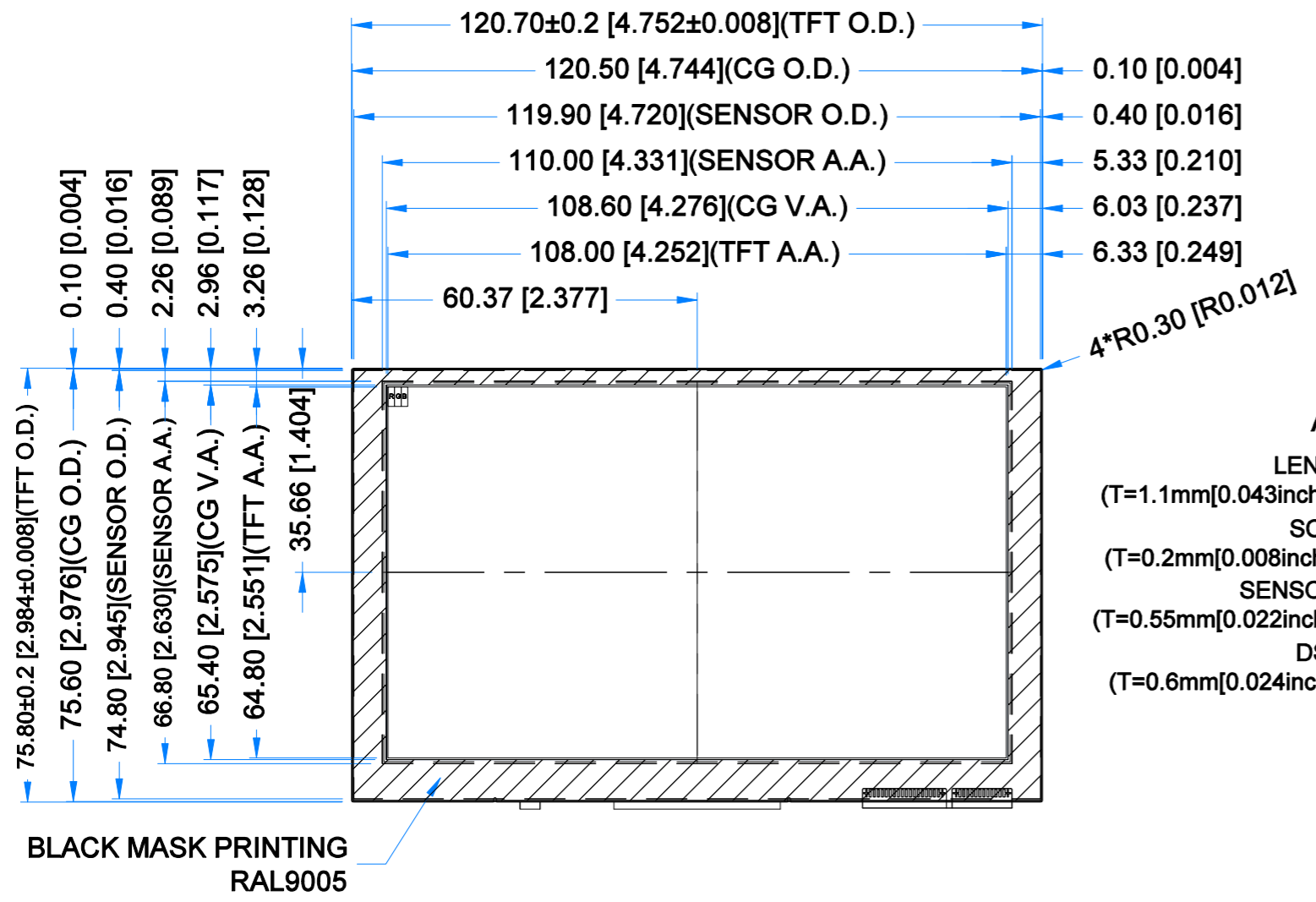

**LCD NOTES:**

1. LCD TYPE: TRANSMISSIVE, NORMALLY BLACK, IPS
2. RESOLUTION: 800x480
3. VIEWING ANGLE: FREE
4. SURFACE LUMINANCE: 800 cd/m<sup>2</sup>
5. DRIVING IC ON THE BOARD: BT817Q
6. INTERFACE: SPI/QSPI
7. SUPPLY VOLTAGE FOR MODULE: 3.3V
8. SUPPLY VOLTAGE FOR BACKLIGHT: 5.0V(TYP.), BUILT-IN LED DRIVER

**TP NOTES:**

1. TP STRUCTURE: G+G
2. CG THICKNESS: 1.10mm[0.043inch]
3. SURFACE HARDNESS: 7H
4. DRIVER IC: ILI2132A
5. INTERFACE: SPI/QSPI VIA RIBUS AND BT817Q

**GENERAL NOTES:**

1. AIR BONDING BETWEEN TFT AND CTP
2. OPERATING TEMPERATURE: -20°C ~ 70°C
3. STORAGE TEMPERATURE: -30°C ~ 80°C
4. WITHOUT INDIVIDUAL TOLERANCE: ±0.3mm[0.012inch]
5. RoHS3 COMPLIANT

PN: RVT50HQBNWCA0

SN:

DRAWN: M.Natywa 2022.08.18

CHECKED: Carol 2022.08.25

APPR:

2022.08.18 1:1.12

2022.08.25 [mm]

ISO A3 P. 1 of 1



| P1-RIBUS CONNECTOR |            |         |             |
|--------------------|------------|---------|-------------|
| Pin No.            | Desc.      | Pin No. | Desc.       |
| 1                  | VDD        | 11      | GPIO.1/IO.2 |
| 2                  | GND        | 12      | GPIO.2/IO.3 |
| 3                  | SPI_SCLK   | 13      | NC          |
| 4                  | MISO/IO.1  | 14      | NC          |
| 5                  | MOSI/IO.0  | 15      | NC          |
| 6                  | CS         | 16      | NC          |
| 7                  | INT        | 17      | BLVDD       |
| 8                  | RST/PD     | 18      | BLVDD       |
| 9                  | GPIO.0     | 19      | BLGND       |
| 10                 | DISP_AUDIO | 20      | BLGND       |

| P2-LOUDSPEAKER OUTPUT CONNECTOR |          |         |          |
|---------------------------------|----------|---------|----------|
| Pin No.                         | Desc.    | Pin No. | Desc.    |
| 1                               | SPEAKER+ | 2       | SPEAKER- |