

| Revision: | Changes:            | Date:      |
|-----------|---------------------|------------|
| 1.0       | Initial Case        | 2020.08.11 |
| 1.1       | Dimensions Overhaul | 2021.07.02 |

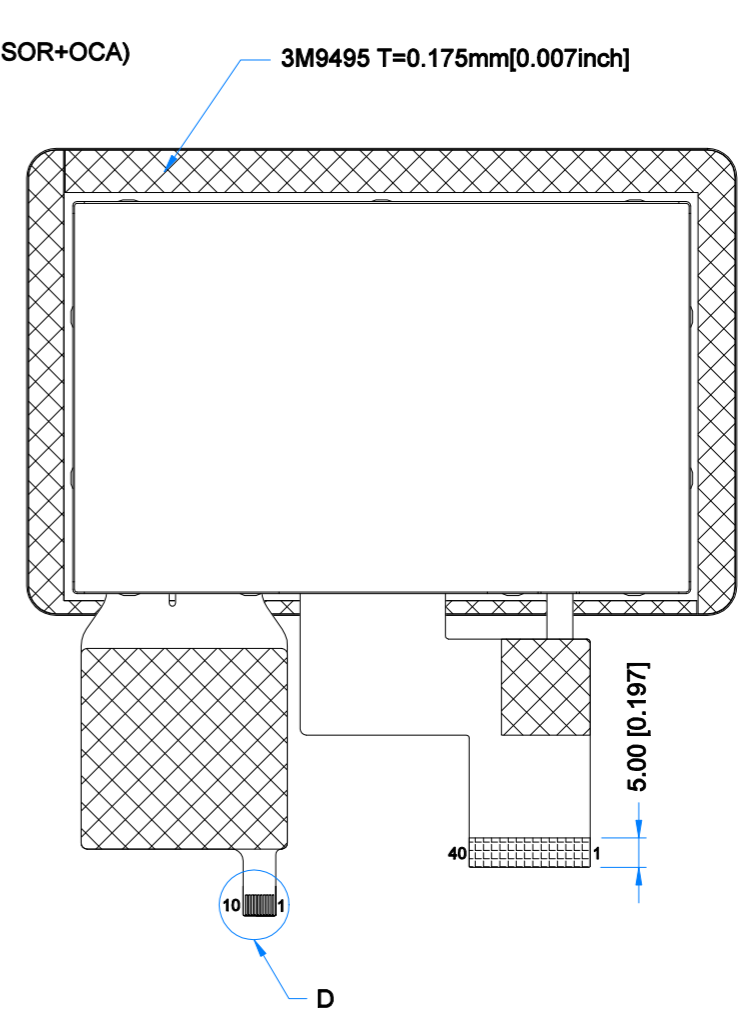

DETAIL A  
SCALE 2:1

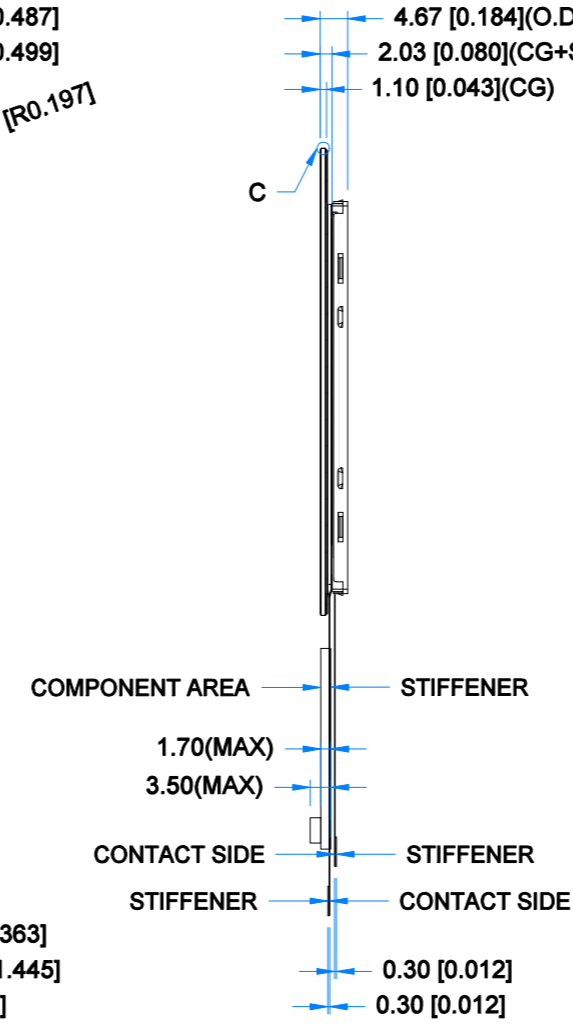
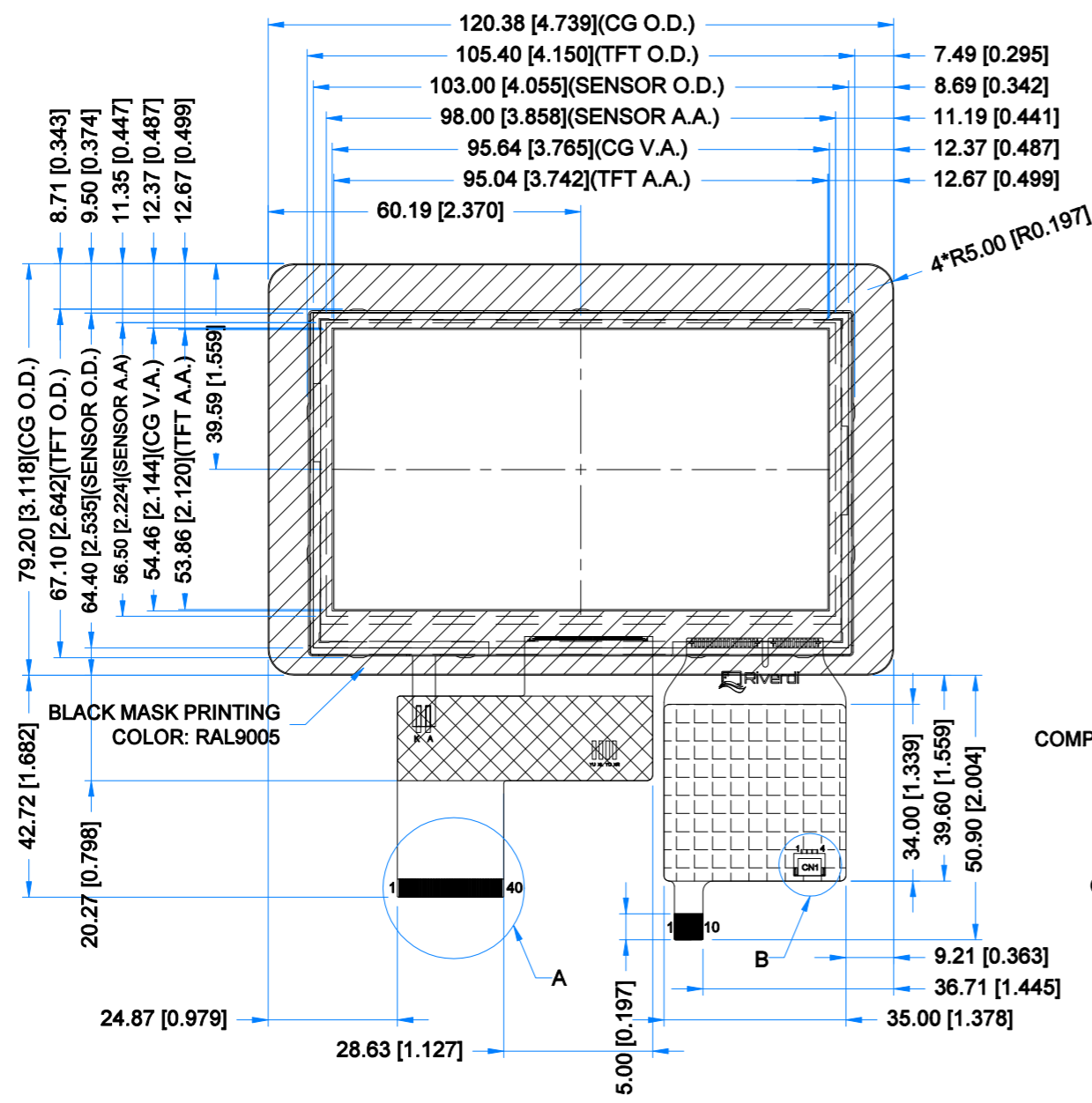
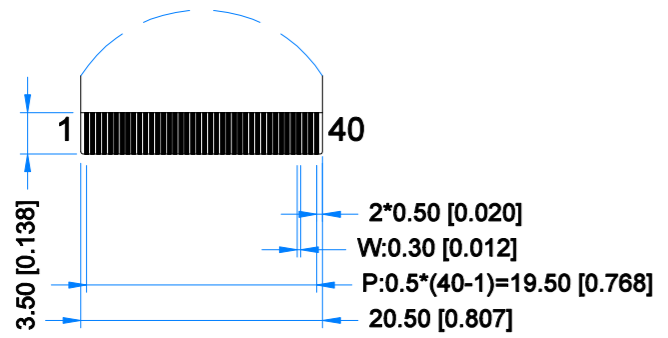

DETAIL B  
SCALE 4:1

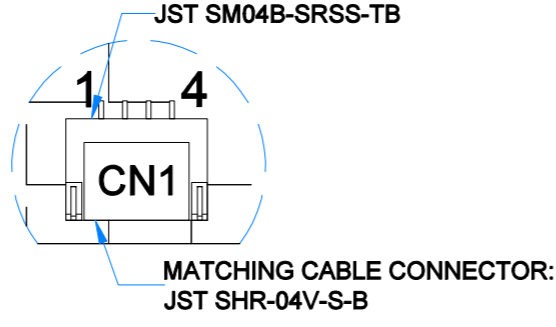

DETAIL C  
SCALE 4:1

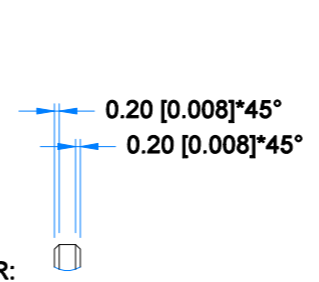

DETAIL D  
SCALE 2:1

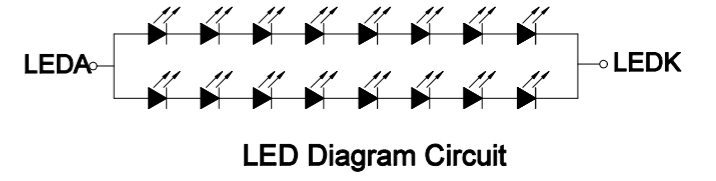
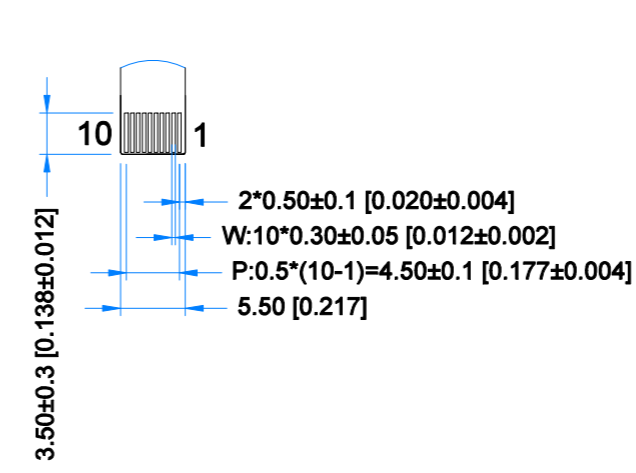

PINOUT ON THE 2ND PAGE

**TFT NOTES:**  
1. LCD TYPE: TRANSMISSIVE, NORMALLY BLACK, IPS  
2. RESOLUTION: 480x272  
3. VIEWING ANGLE: FREE  
4. INTERFACE: RGB  
5. LCD DRIVER: SC7283  
6. LOGIC VOLTAGE: 3.3V  
7. BACKLIGHT: 16 LEDs,  $V_f=25.6V(TYP)$ ,  $I_f=40mA(TYP)$

**TP NOTES:**  
1. TP STRUCTURE: G+G  
2. CG THICKNESS: 1.10mm [0.043inch]  
3. DRIVER IC: ILI2132A  
4. INTERFACE: USB; I2C; OPTIONAL UART  
5. OPERATING VOLTAGE: 3.3V (CTP I2C); 5.0V (CTP USB);

**GENERAL NOTES:**  
1. MODULE SURFACE LUMINANCE: 850 cd/m<sup>2</sup>  
2. OPERATING TEMPERATURE: -20°C ~ 70°C  
3. STORAGE TEMPERATURE: -30°C ~ 80°C  
4. WITHOUT INDIVIDUAL TOLERANCE: ±0.3mm [0.012inch]  
5. RoHS COMPLIANT

|                     |            |           |
|---------------------|------------|-----------|
| PN: RVT43HLTNWC00-B |            |           |
| SN:                 |            |           |
| DRAWN: M.Natywa     | 2021.07.02 | 1:1.28    |
| CHECKED: K.Bodacka  | 2021.07.06 | [mm]      |
| APPR:               | ISO A3     | P. 1 of 1 |



| TFT CONNECTOR |       |         |       |
|---------------|-------|---------|-------|
| Pin No.       | Desc. | Pin No. | Desc. |
| 1             | VLED- | 21      | B0    |
| 2             | VLED+ | 22      | B1    |
| 3             | GND   | 23      | B2    |
| 4             | VDD   | 24      | B3    |
| 5             | R0    | 25      | B4    |
| 6             | R1    | 26      | B5    |
| 7             | R2    | 27      | B6    |
| 8             | R3    | 28      | B7    |
| 9             | R4    | 29      | GND   |
| 10            | R5    | 30      | DCLK  |
| 11            | R6    | 31      | DISP  |
| 12            | R7    | 32      | HSYNC |
| 13            | G0    | 33      | VSYNC |
| 14            | G1    | 34      | DE    |
| 15            | G2    | 35      | NC    |
| 16            | G3    | 36      | GND   |
| 17            | G4    | 37      | NC    |
| 18            | G5    | 38      | NC    |
| 19            | G6    | 39      | NC    |
| 20            | G7    | 40      | NC    |

| TOUCH PANNEL CONNECTOR |               |         |               |
|------------------------|---------------|---------|---------------|
| Pin No.                | Desc.         | Pin No. | Desc.         |
| 1                      | USB_GND       | 6       | I2C_VDD(3.3V) |
| 2                      | USB_VDD(5.0V) | 7       | I2C_RST       |
| 3                      | USB_D-        | 8       | I2C_SCL       |
| 4                      | USB_D+        | 9       | I2C_INT       |
| 5                      | I2C_GND       | 10      | I2C_SDA       |

| CN1     |               |         |         |
|---------|---------------|---------|---------|
| Pin No. | Desc.         | Pin No. | Desc.   |
| 1       | USB_VDD(5.0V) | 3       | USB_D+  |
| 2       | USB_D-        | 4       | USB_GND |