

| | | |
|-----------|--------------|------------|
| Revision: | Changes: | Date: |
| 1.0 | Initial Case | 2021.07.09 |

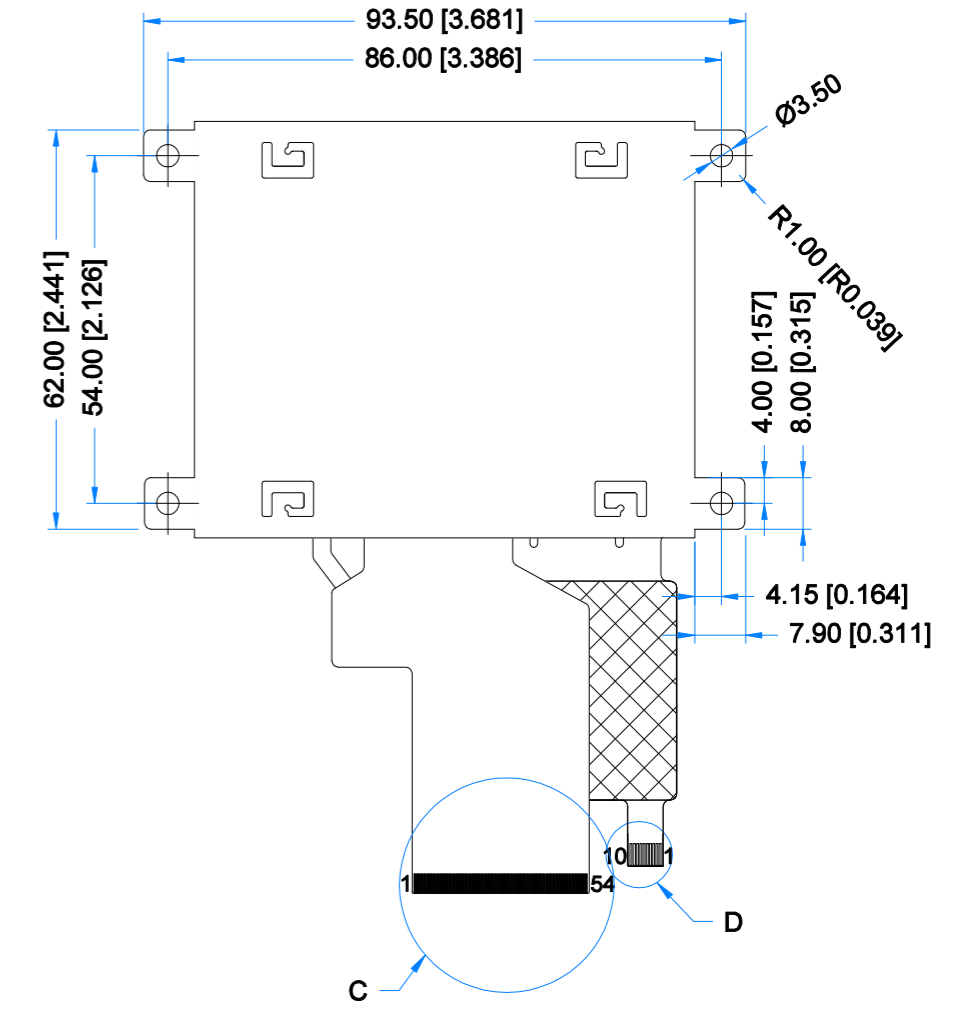

DETAIL A
SCALE 4:1

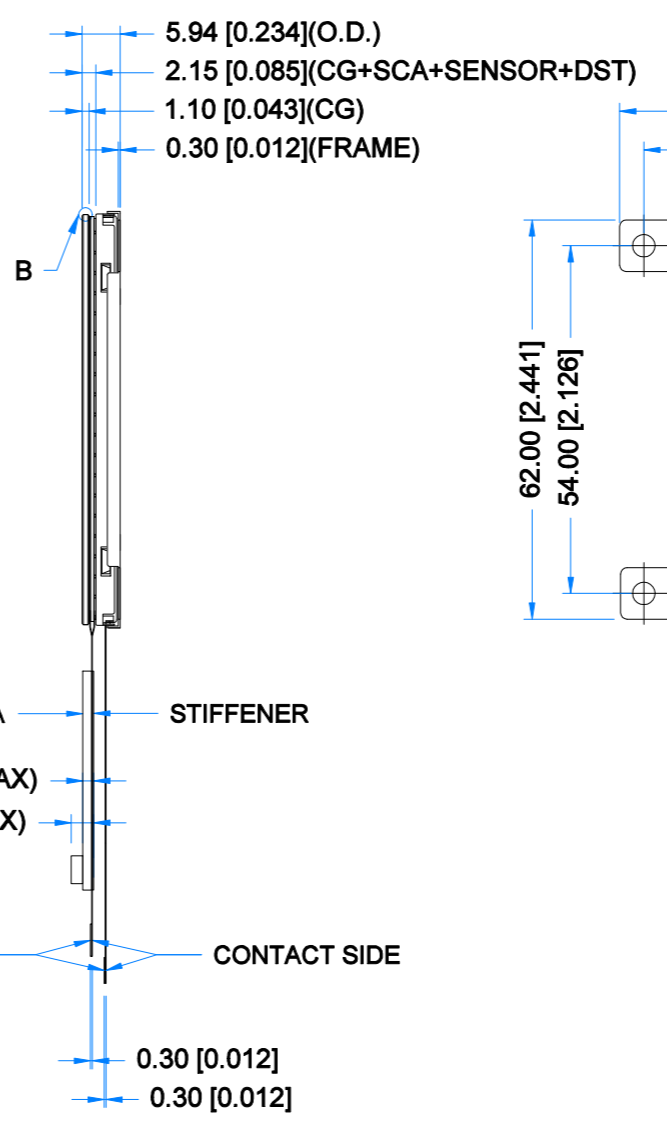
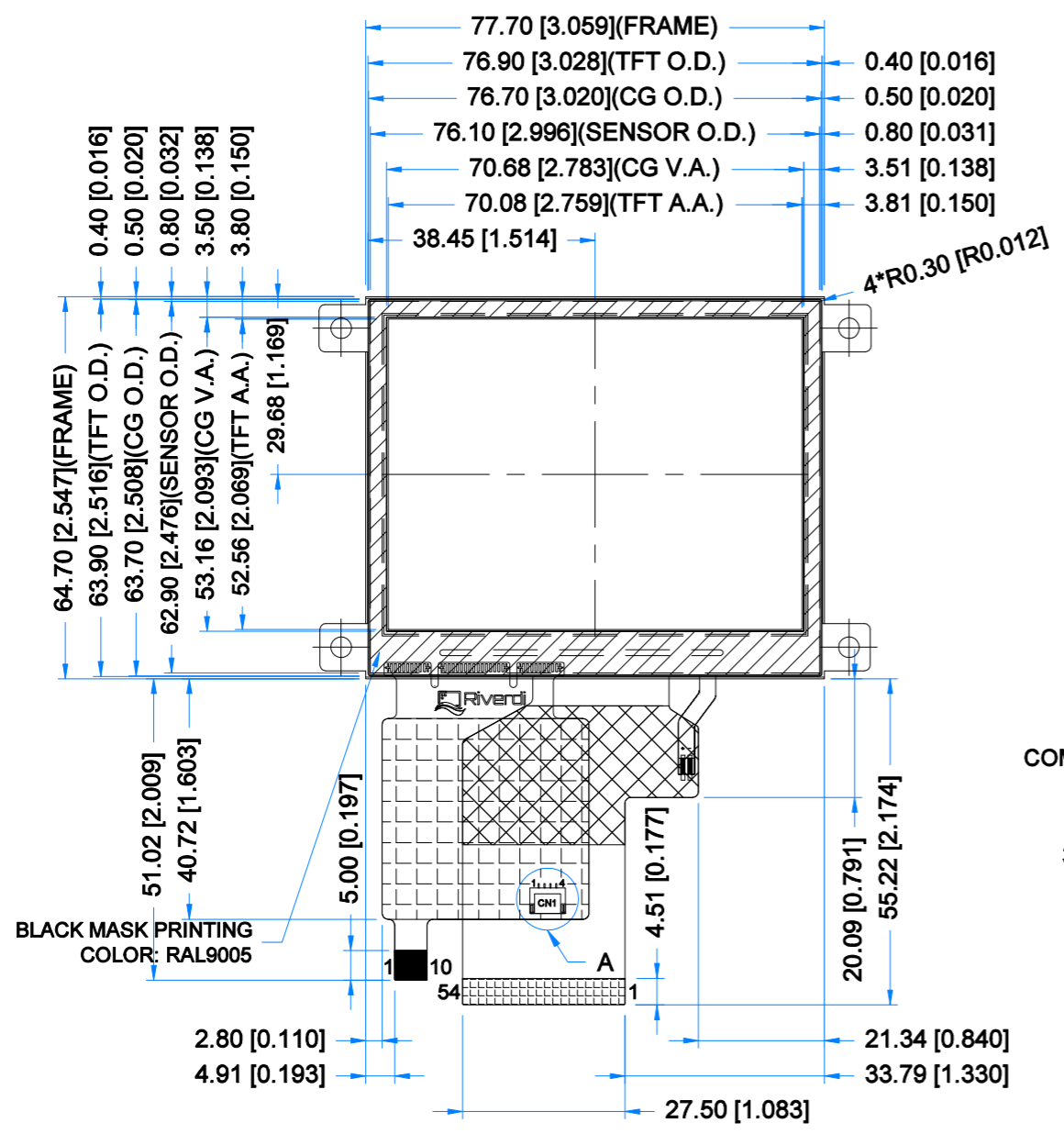
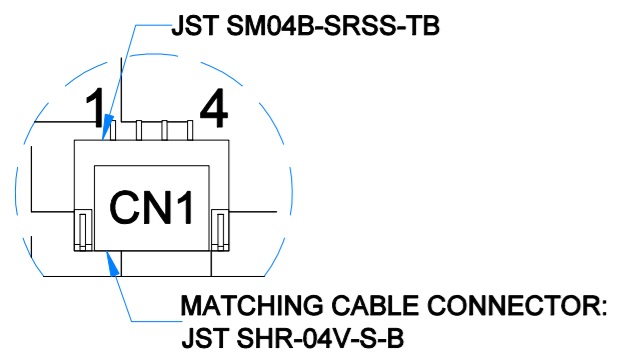

DETAIL B
SCALE 4:1

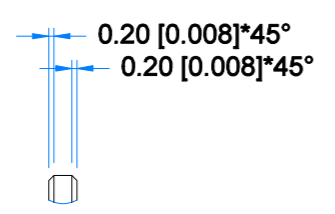

DETAIL C
SCALE 2:1

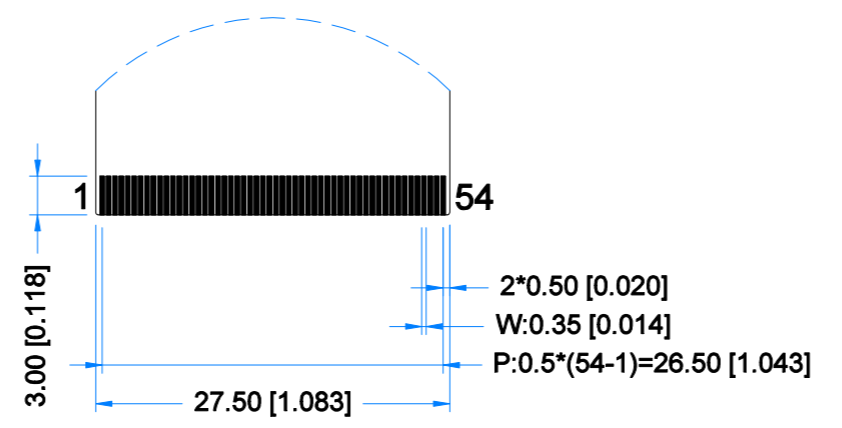

DETAIL D
SCALE 2:1

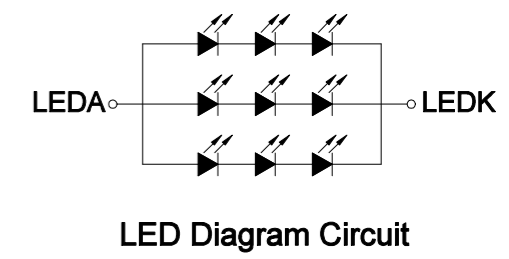
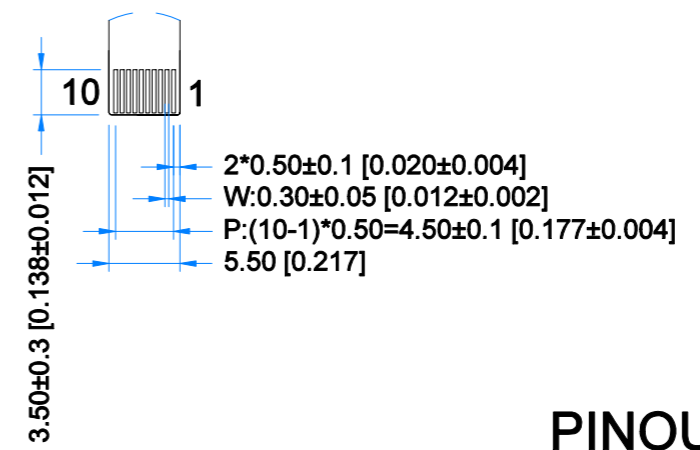

PINOUT ON THE 2ND PAGE

TFT NOTES:
 1. LCD TYPE: TRANSMISSIVE, NORMALLY BLACK, IPS
 2. RESOLUTION: 320x240
 3. VIEWING ANGLE: FREE
 4. DRIVER IC: ST7272A
 5. DRIVING VOLTAGE: 3.3V
 7. BACKLIGHT: 9 LEDS, $V_f=9.6V$, $I_f=60mA$

TP NOTES:
 1. TP STRUCTURE: G+G
 2. CG THICKNESS: 1.10mm [0.043inch]
 3. DRIVER IC: ILI2132A
 4. INTERFACE: USB; I2C; OPTIONAL UART
 5. OPERATING VOLTAGE: 3.3V(CTP I2C); 5.0V(CTP USB);

GENERAL NOTES:
 1. MODULE SURFACE LUMINANCE: 800 cd/m²
 2. OPERATING TEMPERATURE: -20°C ~ 70°C
 3. STORAGE TEMPERATURE: -30°C ~ 80°C
 4. WITHOUT INDIVIDUAL TOLERANCE: ±0.3mm[0.012inch]
 5. RoHS COMPLIANT

| | | | |
|---------------------|------------|--------|--|
| PN: RVT35HHTFWCA0 | | | |
| SN: | | | |
| DRAWN: M.Natywa | 2021.07.09 | 1:1.17 | |
| CHECKED: K.Brodacka | 2021.07.13 | [mm] | |
| APPR: | | | |



| TFT CONNECTOR | | | |
|---------------|-------|---------|--------|
| Pin No. | Desc. | Pin No. | Desc. |
| 1 | LED-K | 28 | R0 |
| 2 | LED-K | 29 | R1 |
| 3 | LED-A | 30 | R2 |
| 4 | LED-A | 31 | R3 |
| 5 | NC | 32 | R4 |
| 6 | NC | 33 | R5 |
| 7 | NC | 34 | R6 |
| 8 | RESET | 35 | R7 |
| 9 | NC | 36 | HSYNC |
| 10 | NC | 37 | VSYNC |
| 11 | NC | 38 | DOTCLK |
| 12 | B0 | 39 | NC |
| 13 | B1 | 40 | NC |
| 14 | B2 | 41 | VDD |
| 15 | B3 | 42 | VDD |
| 16 | B4 | 43 | NC |
| 17 | B5 | 44 | NC |
| 18 | B6 | 45 | NC |
| 19 | B7 | 46 | NC |
| 20 | G0 | 47 | NC |
| 21 | G1 | 48 | NC |
| 22 | G2 | 49 | NC |
| 23 | G3 | 50 | NC |
| 24 | G4 | 51 | NC |
| 25 | G5 | 52 | DEN |
| 26 | G6 | 53 | GND |
| 27 | G7 | 54 | GND |

| TOUCH PANNEL CONNECTOR | | | |
|------------------------|---------------|---------|---------------|
| Pin No. | Desc. | Pin No. | Desc. |
| 1 | USB_GND | 6 | I2C_VDD(3.3V) |
| 2 | USB_VDD(5.0V) | 7 | I2C_RST |
| 3 | USB_D- | 8 | I2C_SCL |
| 4 | USB_D+ | 9 | I2C_INT |
| 5 | I2C_GND | 10 | I2C_SDA |

| CN1 | | | |
|---------|---------------|---------|---------|
| Pin No. | Desc. | Pin No. | Desc. |
| 1 | USB_VDD(5.0V) | 3 | USB_D+ |
| 2 | USB_D- | 4 | USB_GND |