

Revision:	Changes:	Date:
1.0	Initial Case	2025.09.02
1.1	PCBA Position & Gasket Change	2026.01.29
1.2	Updated Front View, Addition Of Cover Glass Detailed View	2026.05.20

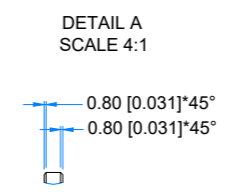
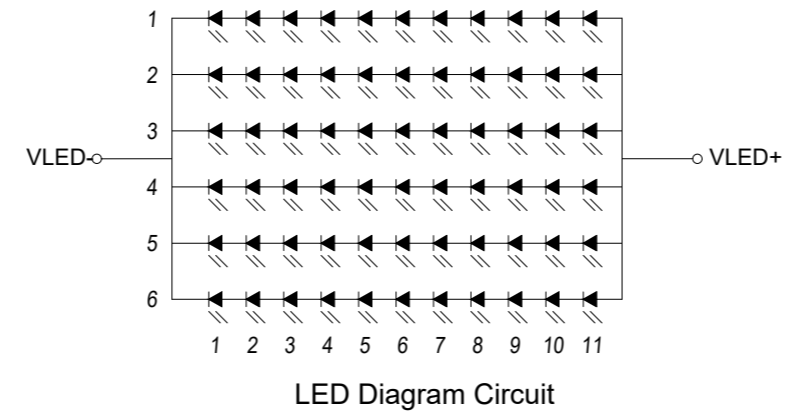
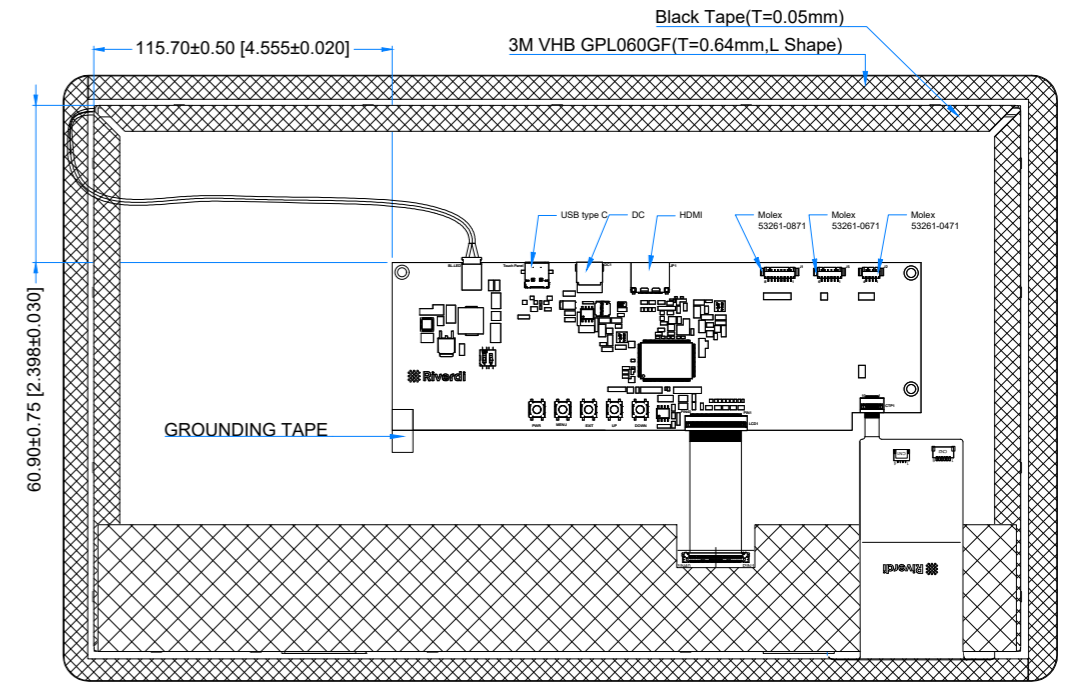
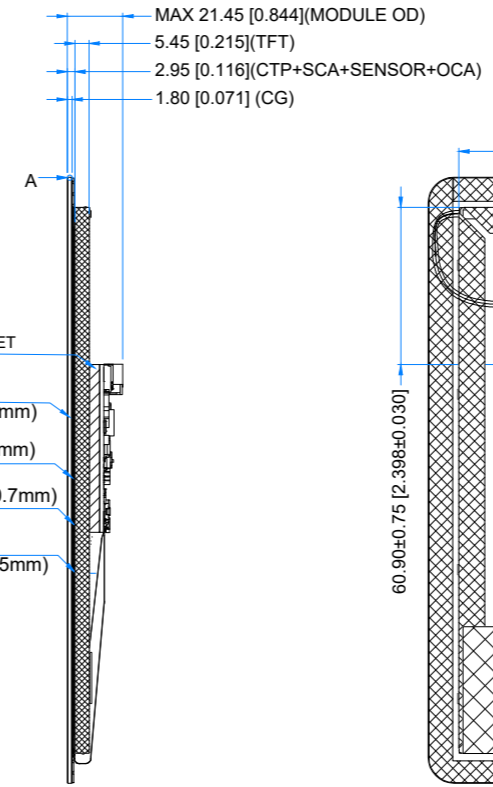
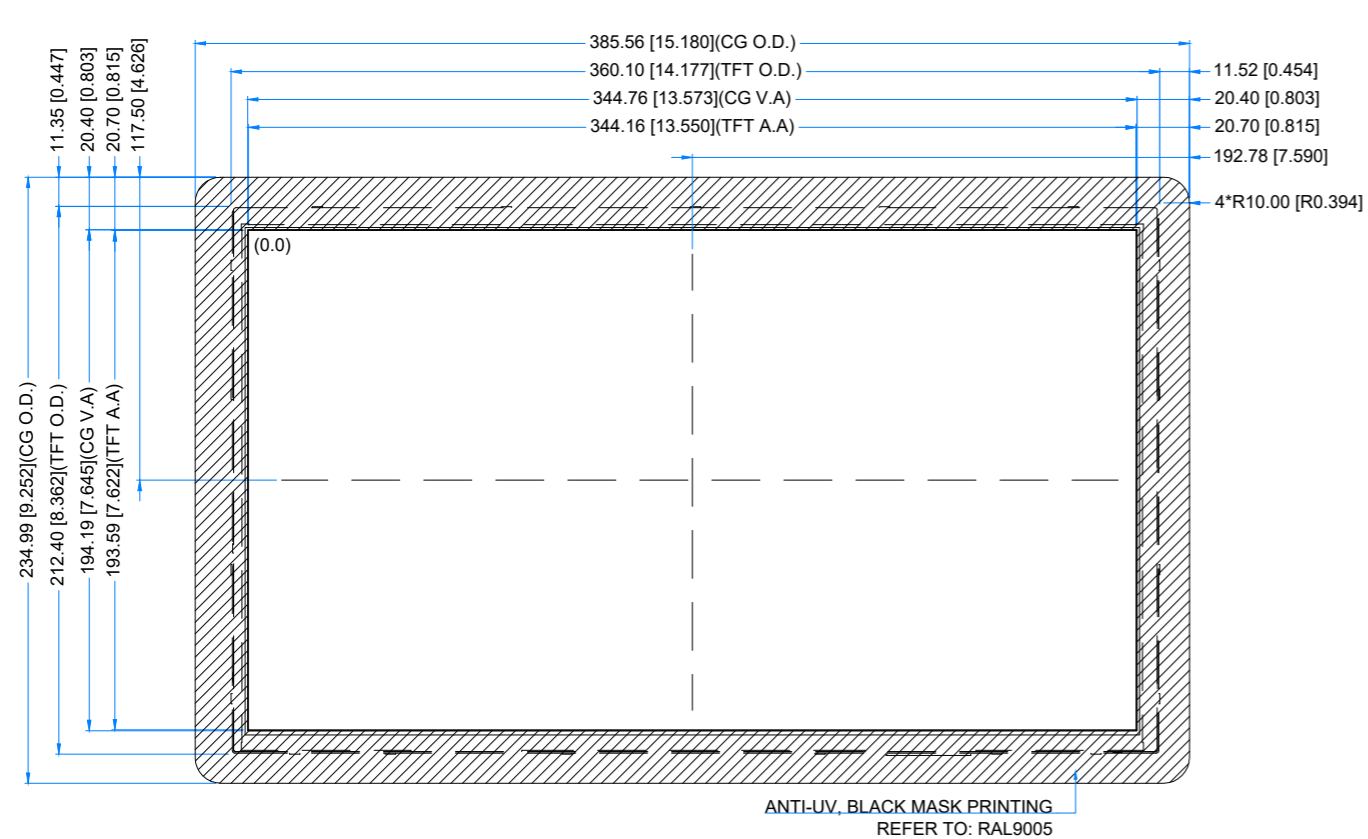

PINOUT ON THE 2ND PAGE

**LCM NOTES:**  
1. LCD TYPE: TRANSMISSIVE, NORMALLY BLACK, IPS  
2. RESOLUTION: 1920x1080  
3. VIEWING ANGLE: FREE  
4. CONTROLLER IC OF MAIN BOARD: RTD2555T  
5. VIDEO INTERFACE: HDMI  
6. POWER SUPPLY: POWER JACK (6.0-27.0V)  
7. MODULE SURFACE LUMINANCE: 850cd/m<sup>2</sup>

**TP NOTES:**  
1. TP STRUCTURE: G+G  
2. CG THICKNESS: 1.8mm[0.071inch]  
3. SURFACE HARDNESS: 6H  
4. DRIVER IC: ILI2510  
5. INTERFACE: USB-C

**GENERAL NOTES:**  
1. OPERATING TEMPERATURE: -20°C ~ 70°C  
2. STORAGE TEMPERATURE: -30°C ~ 80°C  
3. WITHOUT INDIVIDUAL TOLERANCE: ±0.3mm[0.012inch]  
4. RoHS3 COMPLIANT

PN: RVT156HKHNWC00-B  
SN:  
DRAWN: M.Stabinski  
CHECKED: M.Wierzbowski  
APPR: M.Wierzbowski

2026.05.20 1:2.93  
2026.05.20 [mm]  
2026.05.20 ISO A3 P. 1 of 1



EXTERNAL KEYBOARD CONNECTOR - J1			
Pin No.	Desc.	Pin No.	Desc.
1	DOWN	2	UP
3	EXIT	4	MENU
5	PWR	6	LED_EN
7	GND	8	KEYBOARD VDD

BACKLIGHT PWM & POWER - J5			
Pin No.	Desc.	Pin No.	Desc.
1	GND	2	GND
3	EN	4	PWM
5	VDD	6	VDD