

Revision:	Changes:	Date:
1.0	Initial Case	2025.09.02
1.1	PCBA Position & Gasket Change	2026.01.29
1.2	ECO_000398, Addition Of Second Grounding Tape	2026.02.26
1.3	Updated Front View, Addition Of Cover Glass Detailed View	2026.05.20

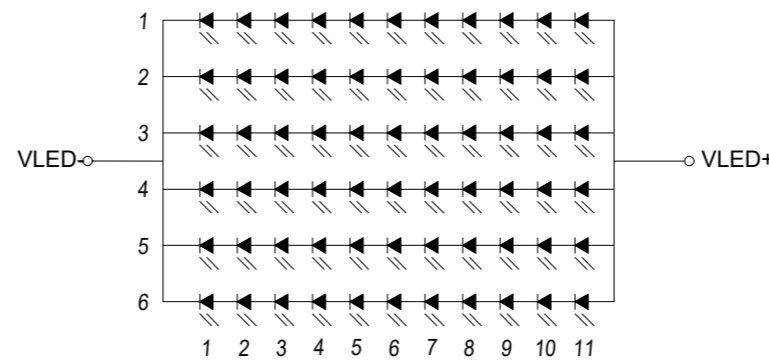

LED Diagram Circuit

DETAIL A
SCALE 4:1

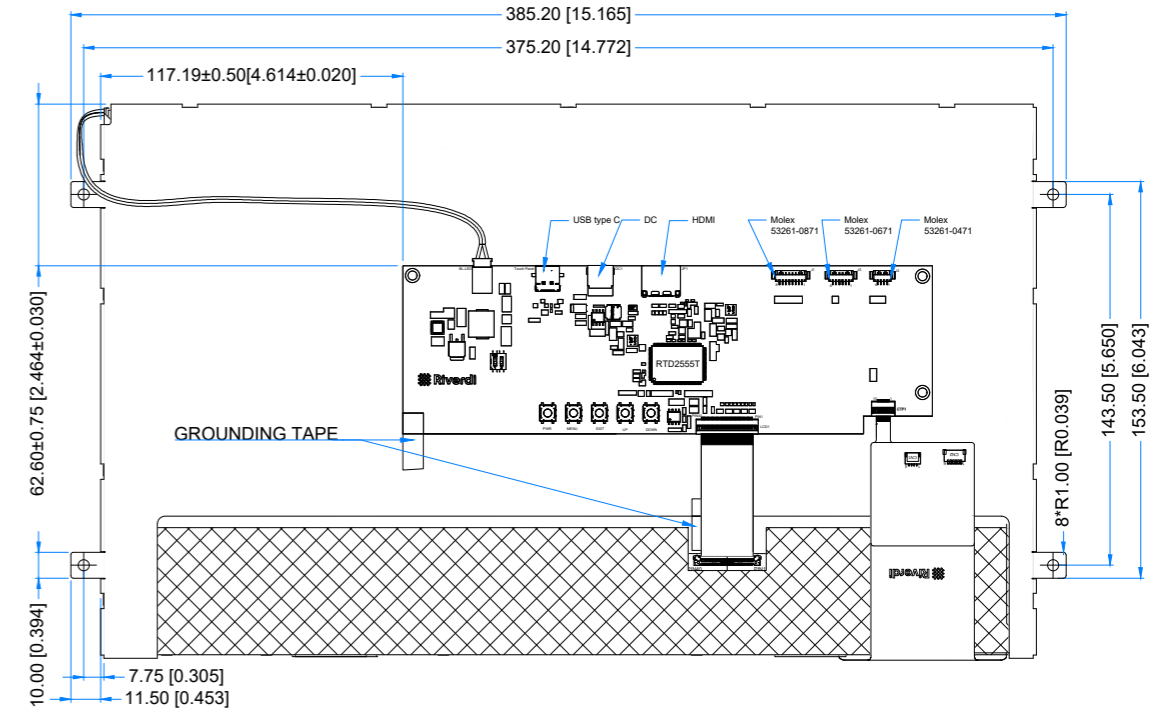
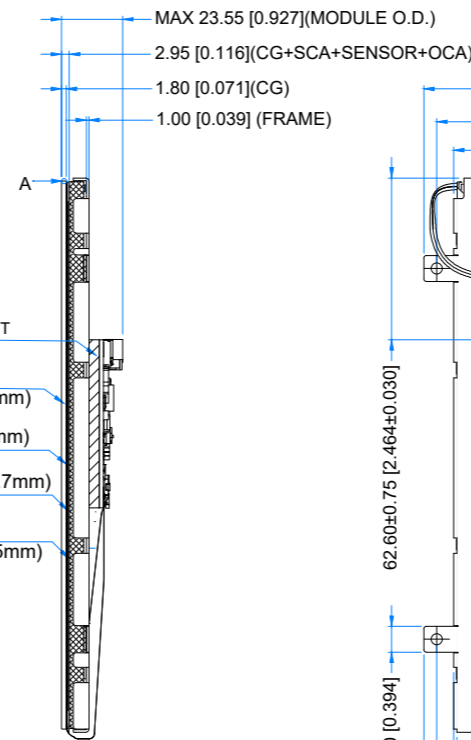
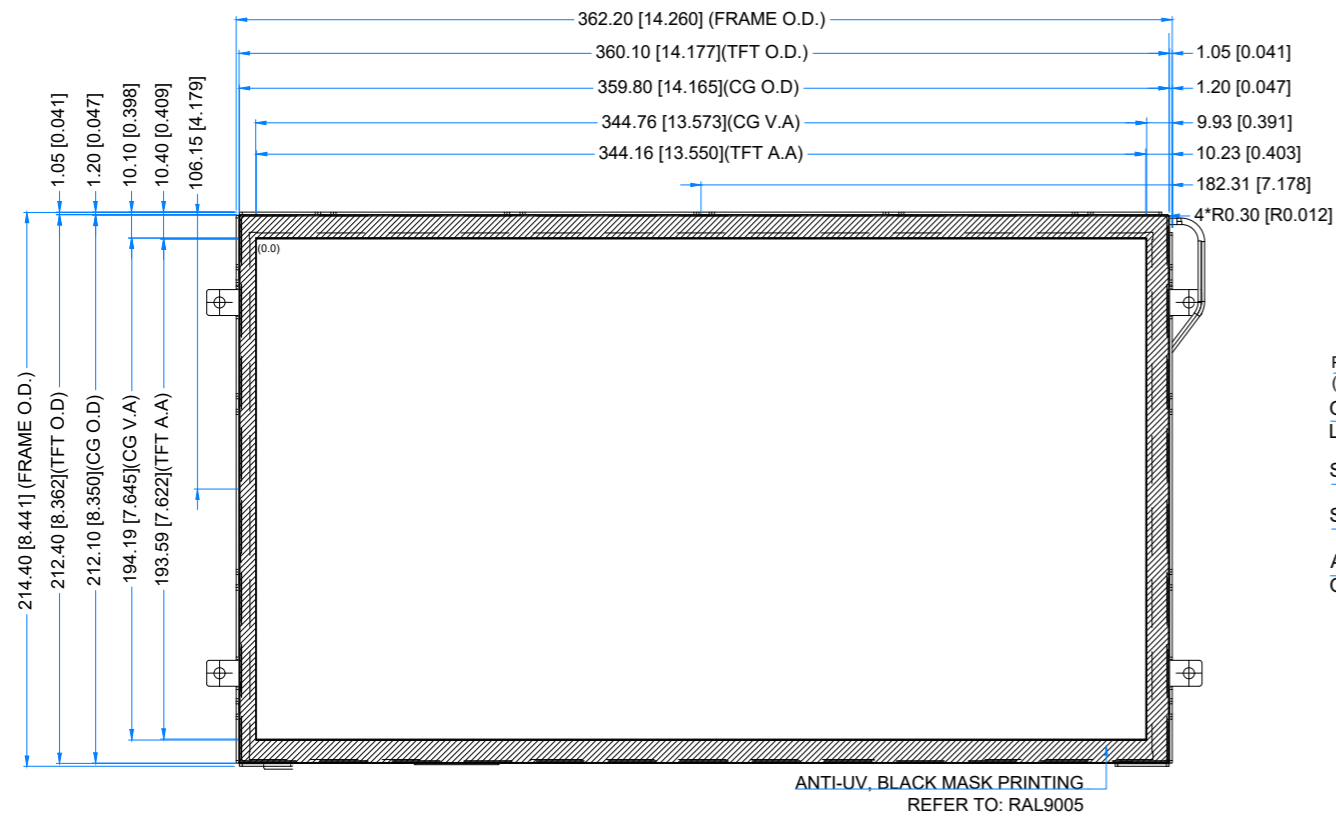
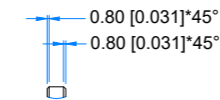

PINOUT ON THE 2ND PAGE

LCM NOTES:
1. LCD TYPE: TRANSMISSIVE, NORMALLY BLACK, IPS
2. RESOLUTION: 1920x1080
3. VIEWING ANGLE: FREE
4. CONTROLLER IC OF MAIN BOARD: RTD2555T
5. VIDEO INTERFACE: HDMI
6. POWER SUPPLY: POWER JACK (6.0-27.0V)
7. MODULE SURFACE LUMINANCE: 850cd/m²

TP NOTES:
1. TP STRUCTURE: G+G
2. CG THICKNESS: 1.8mm[0.071inch]
3. SURFACE HARDNESS: 6H
4. DRIVER IC: ILI2510
5. INTERFACE: USB-C

GENERAL NOTES:
1. OPERATING TEMPERATURE: -20°C ~ 70°C
2. STORAGE TEMPERATURE: -30°C ~ 80°C
3. WITHOUT INDIVIDUAL TOLERANCE:
±0.3mm[0.012inch]
4. RoHS3 COMPLIANT

PN: RVT156HKHFCA0-B

SN:

DRAWN: M.Stabinski

2026.05.20

1:2.93

CHECKED: M.Wierzbowski

2026.05.20

[mm]

APPR: M.Wierzbowski

2026.05.20

ISO A3

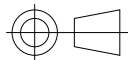



EXTERNAL KEYBOARD CONNECTOR - J1			
Pin No.	Desc.	Pin No.	Desc.
1	DOWN	2	UP
3	EXIT	4	MENU
5	PWR	6	LED_EN
7	GND	8	KEYBOARD VDD

BACKLIGHT PWM & POWER - J5			
Pin No.	Desc.	Pin No.	Desc.
1	GND	2	GND
3	EN	4	PWM
5	VDD	6	VDD