

Revision:	Changes:	Date:
1.0	Initial Case	2024.03.19
1.1	PCB Position Update	2024.08.19
1.2	Changed the CG VA dimension	2025.02.03

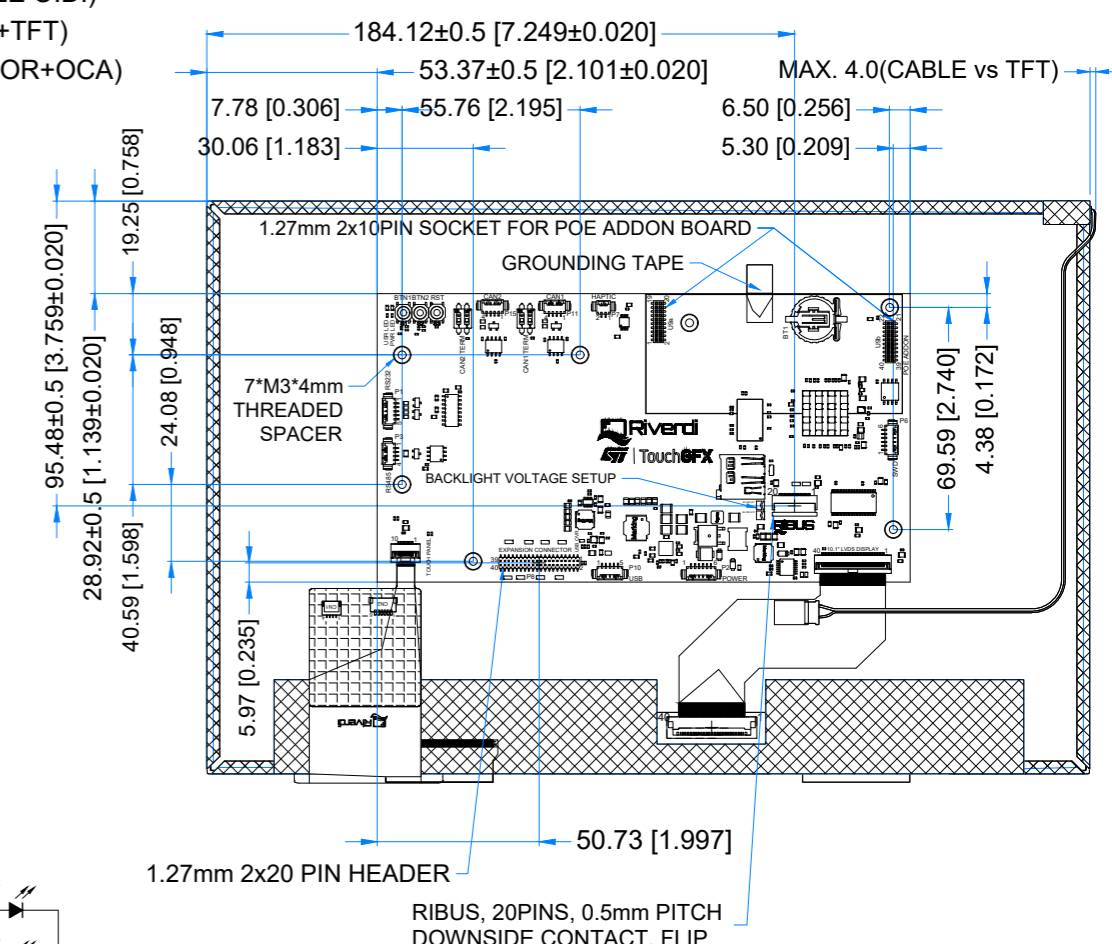

BLACK MASK PRINTING  
COLOR: RAL9005

DETAIL A  
SCALE 4:1

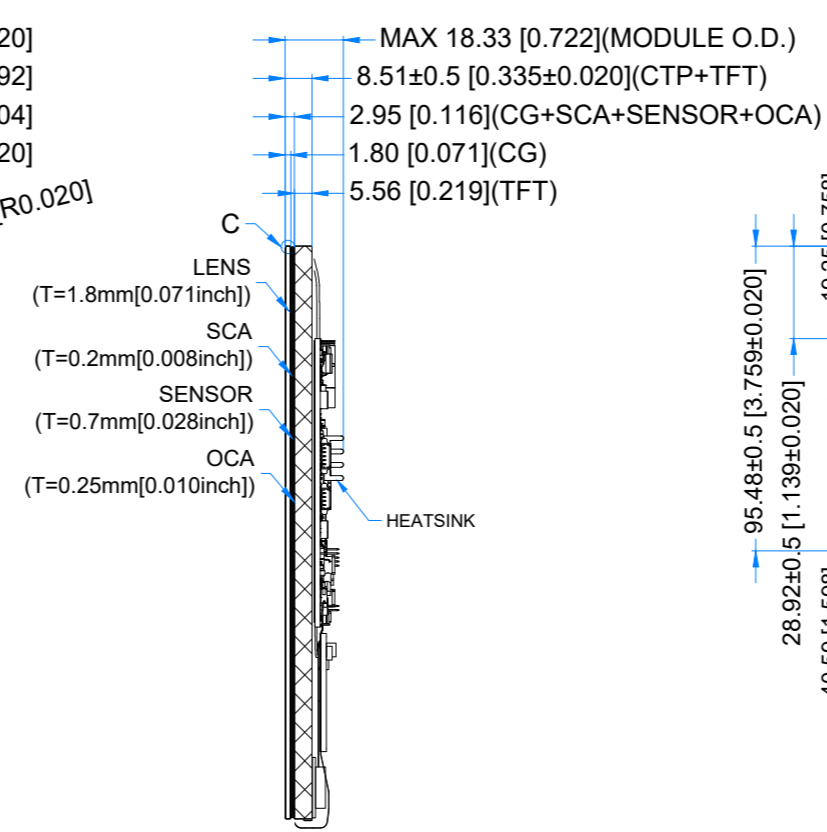
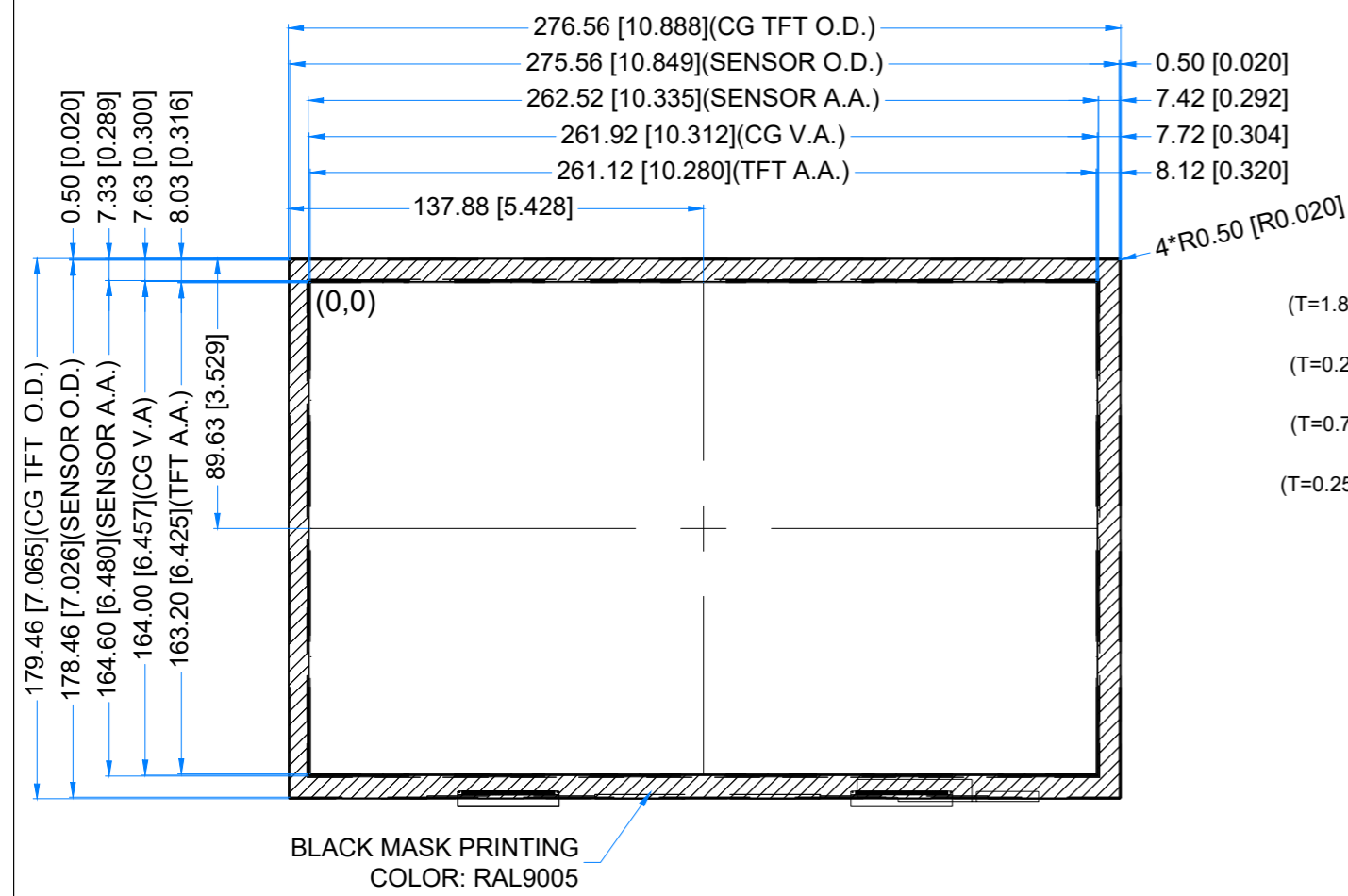
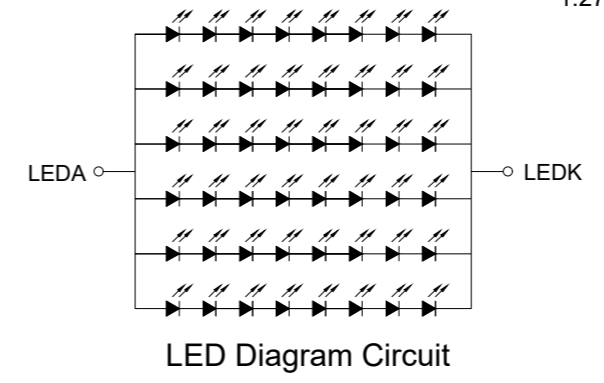
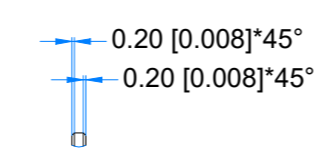

### 1.25 MM MOLEX CONNECTORS

NO.	TYPE	MATE WITH
P1 (RS232)	53261-0571	51021-0500
P2 (POWER)	53261-0671	51021-0600
P3 (RS485)	53261-0471	51021-0400
P6 (SWD)	53261-0671	51021-0600
P7 (HAPTIC)	53261-0271	51021-0200
P10 (USB)	53261-0571	51021-0500
P11 (CAN1)	53261-0471	51021-0400
P15 (CAN2)	53261-0471	51021-0400

### 1.27MM PIN HEADER AND SOCKET

NO.	TYPE	MATE WITH
P8	CH51402M100-0P	CBC1402D100 OR CBC1402M100-2P
U9a & U9b	PBHTD20SPP-JL	CH51202V100 OR CH51202M100-0P
P13	62131021021	62200213421 (JUMPER)

**LCD NOTES:**  
 1. LCD TYPE: TRANSMISSIVE, NORMALLY BLACK, IPS  
 2. RESOLUTION: 1280x800  
 3. VIEWING ANGLE: FREE  
 4. SURFACE LUMINANCE: 850 cd/m<sup>2</sup>  
 5. MCU ON THE BOARD: STM32H757XIH6  
 6. EXTERNAL FLASH MEMORY SIZE: 512Mbit  
 7. EXTERNAL SDRAM SIZE: 64Mbit (32-bit access)  
 8. SUPPLY VOLTAGE FOR MODULE: 6.0V - 48.0V

**TP NOTES:**  
 1. TP STRUCTURE: G+G  
 2. CG THICKNESS: 1.80mm  
 3. SURFACE HARDNESS: 6H  
 4. DRIVER IC: ILI2511  
 5. INTERFACE: CONNECTED TO MCU VIA I2C

**GENERAL NOTES:**  
 1. OPERATING TEMPERATURE: -20°C ~ 70°C  
 2. STORAGE TEMPERATURE: -30°C ~ 80°C  
 3. WITHOUT INDIVIDUAL TOLERANCE: ±0.3mm[0.012inch]  
 4. TOLERANCE OF PCB PLACEMENT: ±0.5mm[0.020inch]  
 5. RoHS3 COMPLIANT

PN: RVT121HVSNWCA0-B  
 SN:  
 DRAWN: M.Suchocki 2025.02.03 1:2.37  
 CHECKED: M.Wierzbowski 2025.02.03 [mm]  
 APPR:

ISO A3 P. 1 of 1