

Revision:	Changes:	Date:
1.0	Initial Case	2021.06.16
1.1	PCB Update And Dimensions Overhaul	2022.01.05

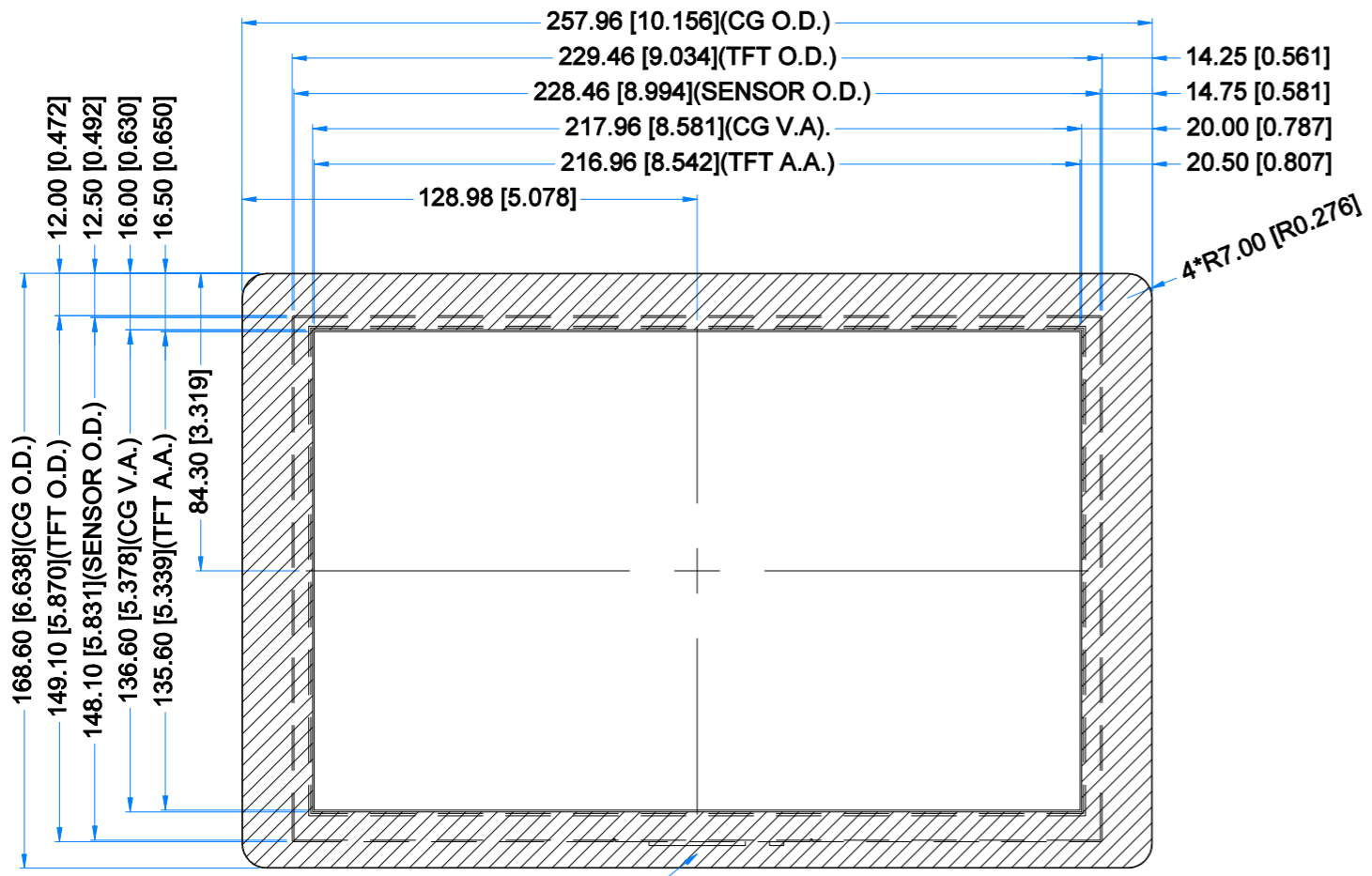

BLACK MASK PRINTING  
COLOR: RAL9005

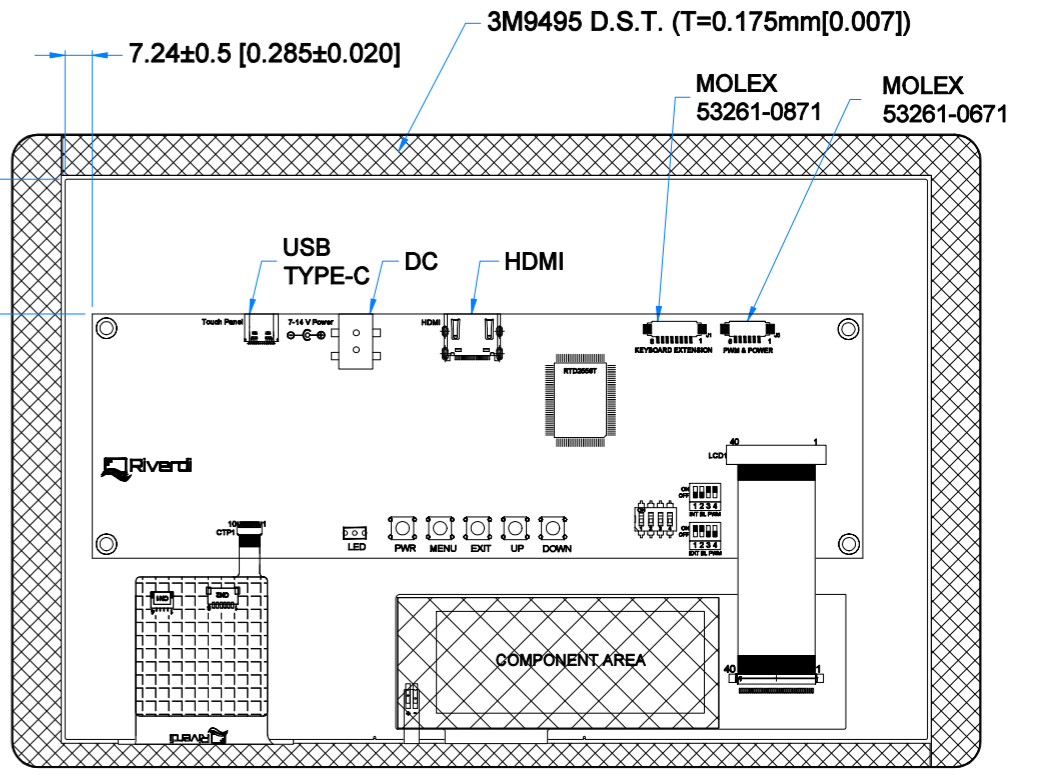
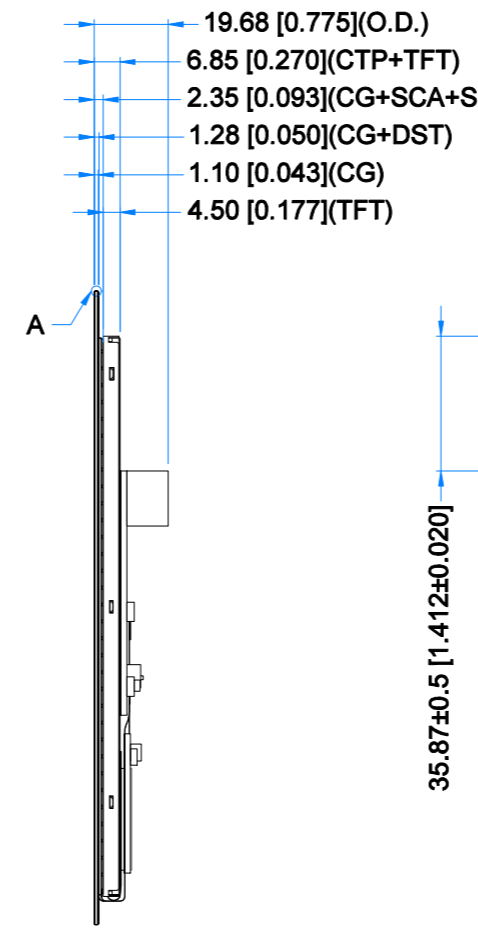

DETAIL A  
SCALE 4:1

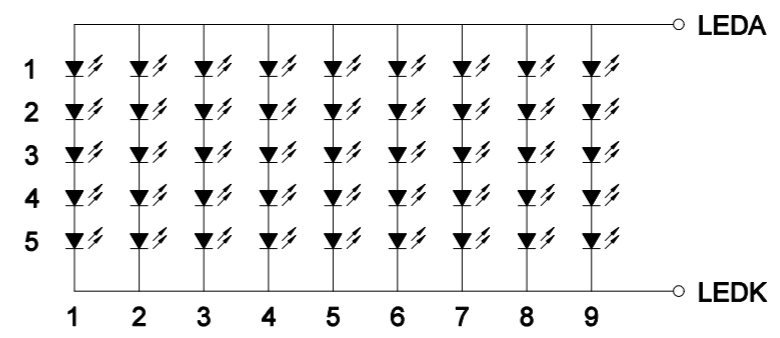
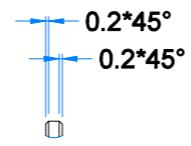

LED Diagram Circuit

**LCM NOTES:**  
 1. LCD TYPE: TRANSMISSIVE, NORMALLY BLACK, IPS  
 2. RESOLUTION: 1280x800  
 3. VIEWING ANGLE: FREE  
 4. CONTROLLER IC OF MAIN BOARD: RTD256T  
 5. VIDEO INTERFACE: HDMI  
 6. POWER SUPPLY: POWER JACK (7.0-14.0V)  
 7. MODULE SURFACE LUMINANCE:Max.800cd/m<sup>2</sup>  
 8. ZERO BAD PIXEL

**TP NOTES:**  
 1. TP STRUCTURE: G+G  
 2. CG THICKNESS: 1.10mm[0.043inch]  
 3. SURFACE HARDNESS: 7H  
 4. DRIVER IC: ILI2132A  
 5. INTERFACE: USB-C

**GENERAL NOTES:**  
 1. MODULE SURFACE LUMINANCE: Max.800 cd/m<sup>2</sup>  
 2. OPERATING TEMPERATURE: -20°C ~ 70°C  
 3. STORAGE TEMPERATURE: -30°C ~ 80°C  
 4. WITHOUT INDIVIDUAL TOLERANCE:  
 ±0.3mm[0.012inch]  
 5. RoHS3 COMPLIANT

PN: RVT101HVHNWC00  
 SN:  
 DRAWN: M.Natywa 2022.01.05 1:2.01  
 CHECKED: Carol Gao 2022.01.11 [mm]  
 APPR: Carol Gao 2022.01.11 ISO A3

P. 1 of 1



EXTERNAL KEYBOARD CONNECTOR - J1			
Pin No.	Desc.	Pin No.	Desc.
1	DOWN	2	UP
3	EXIT	4	MENU
5	PWR	6	LED_EN
7	GND	8	KEYBOARD VDD

BACKLIGHT PWM & POWER - J5			
Pin No.	Desc.	Pin No.	Desc.
1	GND	2	GND
3	EN	4	PWM
5	VDD	6	VDD