

Revision:	Changes:	Date:
1.0	Initial Case	2023.08.28

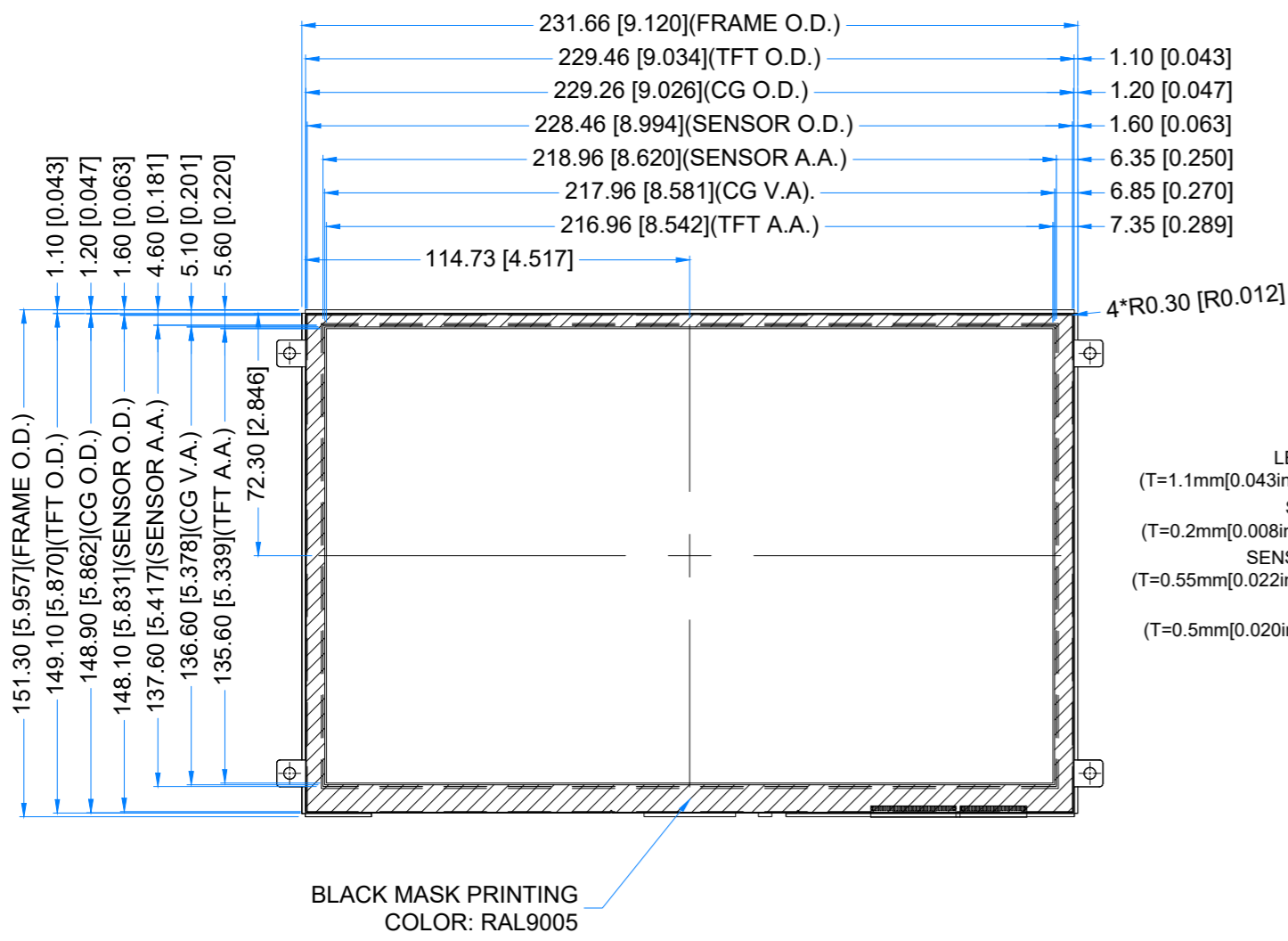

BLACK MASK PRINTING  
COLOR: RAL9005

- LENS  
(T=1.1mm[0.043inch])
- SCA  
(T=0.2mm[0.008inch])
- SENSOR  
(T=0.55mm[0.022inch])
- DST  
(T=0.5mm[0.020inch])

DETAIL A  
SCALE 4:1

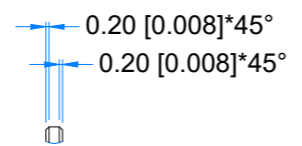

- MAX 14.40 [0.567] (MODULE O.D.)
- 8.08 [0.318] (CTP+TFT+FRAME)
- 2.35 [0.093] (CG+SCA+SENSOR+DST)
- 1.10 [0.043] (CG)
- 1.00 [0.039] (FRAME)

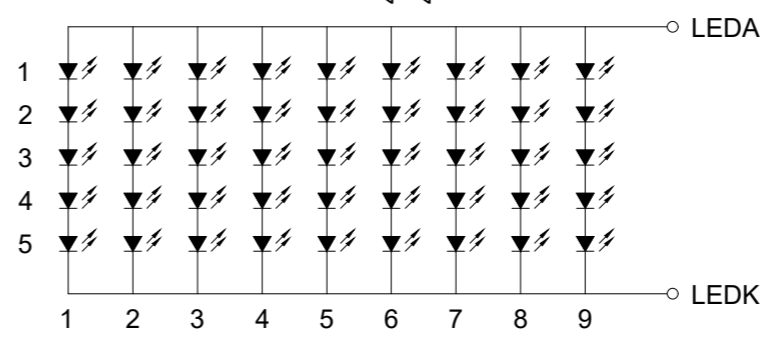
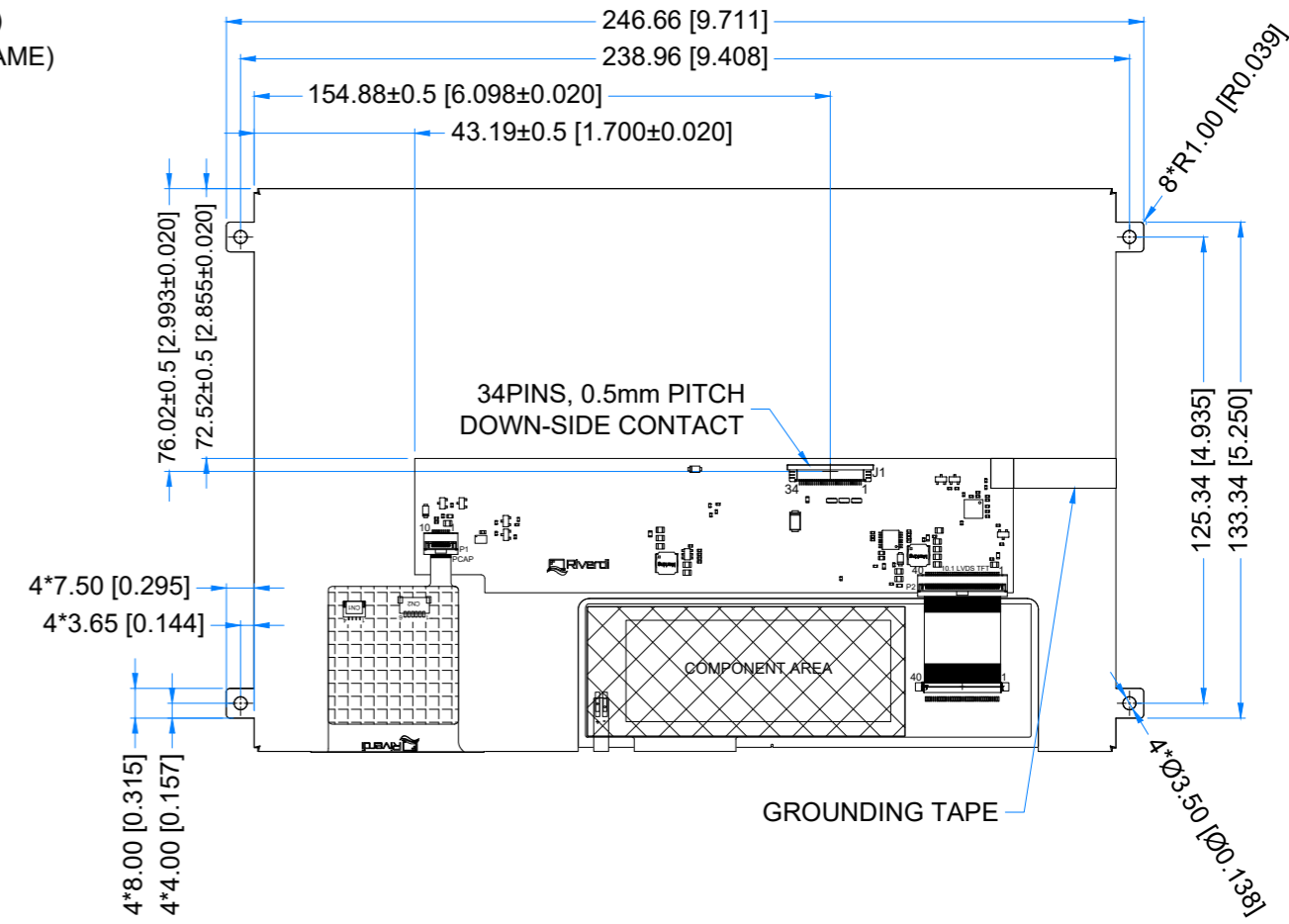

LED Diagram Circuit

PINOUT ON THE 2ND PAGE

**LCD NOTES:**  
 1. LCD TYPE: TRANSMISSIVE, NORMALLY BLACK, IPS  
 2. RESOLUTION: 1280x800  
 3. VIEWING ANGLE: FREE  
 4. SURFACE LUMINANCE: 800 cd/m<sup>2</sup>  
 5. DRIVING IC ON THE BOARD: SN65DSI83ZXHR  
 6. INTERFACE: MIPI DSI  
 7. SUPPLY VOLTAGE FOR MODULE: 5.0 V

**TP NOTES:**  
 1. TP STRUCTURE: G+G  
 2. CG THICKNESS: 1.10mm[0.043inch]  
 3. SURFACE HARDNESS: 7H  
 4. DRIVER IC: ILI2132A  
 5. INTERFACE: I2C INTERFACE

**GENERAL NOTES:**  
 1. ZERO BAD PIXELS FOR TFT  
 2. AIR BONDING  
 3. OPERATING TEMPERATURE: -20°C ~ 70°C  
 4. STORAGE TEMPERATURE: -30°C ~ 80°C  
 5. WITHOUT INDIVIDUAL TOLERANCE:  
 ±0.3mm[0.012inch]  
 6. RoHS COMPLIANT

PN: RVT101HVDFWCA0			
SN:			
DRAWN: M.Natywa	2023.08.28	1:2.01	
CHECKED: Carol Gao	2023.09.04	[mm]	
APPR:		ISO A3	